

# Licensing Sub-Committee Report

Item No:	
Date:	23 June 2022
Licensing Ref No:	22/03444/LIPN - New Premises Licence
Title of Report:	13 Eccleston Yard City Of Westminster London SW1W 9AZ
Report of:	Director of Public Protection and Licensing
Wards involved:	Pimlico North
Policy context:	City of Westminster Statement of Licensing Policy
Financial summary:	None
Report Author:	Miss Jessica Donovan Senior Licensing Officer
Contact details	Telephone: 020 7641 6500 Email: <a href="mailto:jdonovan@westminster.gov.uk">jdonovan@westminster.gov.uk</a>

## 1. Application

1-A Applicant and premises			
<b>Application Type:</b>	New Premises Licence, Licensing Act 2003		
<b>Application received date:</b>	30 March 2022		
<b>Applicant:</b>	Amie Wine Ltd		
<b>Premises:</b>	N/A		
<b>Premises address:</b>	13 Eccleston Yard City Of Westminster London SW1W 9AZ	<b>Ward:</b>	Pimlico North
		<b>Cumulative Impact Area:</b>	None
		<b>Special Consideration Zone:</b>	None
<b>Premises description:</b>	The premises intends to operate as a pop-up wine shop with a small ancillary bar for a time limited period of six months from the date of grant.		
<b>Premises licence history:</b>	The premises have had the benefit of the use of Temporary Event Notices but does not have an existing premises licence. A copy of the history can be found at <b>Appendix 3</b> .		
<b>Applicant submissions:</b>	Following consultation, the applicant provided a mediation email for the interested which can be found at <b>Appendix 2</b> .		
<b>Applicant amendments:</b>	None		

1-B Proposed licensable activities and hours							
<b>Sale by retail of alcohol</b>				<b>On or off sales or both:</b>			Both
<b>Day:</b>	<b>Mon</b>	<b>Tues</b>	<b>Wed</b>	<b>Thur</b>	<b>Fri</b>	<b>Sat</b>	<b>Sun</b>
<b>Start:</b>	09:00	09:00	09:00	09:00	09:00	09:00	09:00
<b>End:</b>	22:30	22:30	22:30	23:00	23:00	23:00	21:30
<b>Seasonal variations/ Non-standard timings:</b>		N/A					

Hours premises are open to the public							
<b>Day:</b>	<b>Mon</b>	<b>Tues</b>	<b>Wed</b>	<b>Thur</b>	<b>Fri</b>	<b>Sat</b>	<b>Sun</b>
<b>Start:</b>	07:30	07:30	07:30	07:30	07:30	07:30	07:30
<b>End:</b>	23:00	23:00	23:00	23:30	23:30	23:30	22:00
<b>Seasonal variations/ Non-standard timings:</b>		N/A					

## 2. Representations

2-A Responsible Authorities	
<b>Responsible Authority:</b>	Environmental Health Service ( <i>Withdrawn 28<sup>th</sup> April 2022</i> )
<b>Representative:</b>	Dave Nevitt
<b>Received:</b>	27 April 2022
<p>I wish to make Representations on the following grounds:</p> <p>Representation is made in relation to the application, as the proposals are likely to increase the risk of Public Nuisance and may impact upon Public Safety.</p> <p><b><i>Following further discussions with the applicant and the district surveyor, the Environmental Health Service withdrew their representation on 28<sup>th</sup> April 2022.</i></b></p>	

2-B Other Persons	
<b>Name:</b>	[REDACTED]
<b>Address and/or Residents Association:</b>	[REDACTED] [REDACTED] [REDACTED]
<b>Status:</b>	Valid
<b>In support or opposed:</b>	Opposed
<b>Received:</b>	26 April 2022
<p>Following the receipt of a notification of a new premises licence application (22/03444/LIPN), I am writing on behalf of [REDACTED] to make representations. Please see below the arguments against the licence's approval:</p> <p>Noise Nuisance - Exposure to noises associated with night life and catering activities - including bars and pubs - cause great disturbance and can negatively impact the residents' health on the long-term. That is already the case with the Lime Tree Hotel from which sounds travel considering the open gardens.</p> <p>Noise Pollution - The propagation of noises caused by outdoor cooling compressor is above the limit allowed in the city of Westminster.</p> <p>No Premises Licence Variations - The conditions stated in the licence remain unchanged. The new premises licence application had already been assessed and rejected under similar circumstances. - consequently, the outcome should remain the same.</p> <p>Neighbourhood Change- The project may change the entire concept of the Eccleston Yard which is family-oriented, thereby overall negatively impacting the residents' well-being and potentially causing residential stress.</p>	

### 3. Policy & Guidance

The following policies within the City Of Westminster Statement of Licensing Policy apply:

#### Policy HRS1 applies

- A. Applications within the core hours set out below in this policy will generally be granted for the relevant premises uses, subject to not being contrary to other policies in the Statement of Licensing Policy.
- B. Applications for hours outside the core hours set out in Clause C will be considered on their merits, subject to other relevant policies, and with particular regard to the following:
1. The demonstration of compliance in the requirements of policies CD1, PS1, PN1 and CH1 associated with the likelihood of the effect of the grant of a licence for later or earlier hours on crime and disorder, public safety, public nuisance and the protection of children from harm.
  2. If the application is located within a Special Consideration Zone they have demonstrated that they have taken account of the issues identified in that area and provided adequate mitigation.
  3. Whether there is residential accommodation in the proximity of the premises that would likely be adversely affected by premises being open or carrying out operations at the hours proposed.
  4. The proposed hours of the licensable activities and when customers will be permitted to remain on the premises.
  5. The proposed hours when any music, including incidental music, will be played.
  6. The hours when customers will be allowed to take food or drink outside the premises or be within open areas which form part of the premises.
  7. The existing hours of licensable activities and the past operation of the premises (if any) and hours of licensable premises in the vicinity.
  8. Whether customers and staff have adequate access to public transport when arriving at and leaving the premises, especially at night.
  9. The capacity of the premises.
  10. The type of use, recognising that some venues are more likely to impact the licensing objectives than others; for example, pubs and bars are higher risk than theatres, cinemas and other cultural and sporting venues due to the nature of the operation.
  11. The Licensing Authority will take into account the active measures proposed for a 'winding down' period including arrangements for people to be collected from the premises to travel home safely.
  12. Conditions on hours may be attached that require that the supply of alcohol for consumption on the premises ceases a suitable period of time before customers are required to leave the premises.
  13. The council, acting as the Licensing Authority, may reduce hours if, after review, it is necessary to impose conditions specifying shorter hours in order to promote the licensing objectives.
  14. Specific days for non-standard hours should be identified and justified as part of the application to allow responsible authorities and interested parties to evaluate the impact that these licensable activities may have, and to plan accordingly. The consideration of applications for later hours for Bank Holiday Mondays will take into account that later hours are generally granted for preceding Sundays and that the next day is a working day. Non-specific days

	<p>are expected to be covered by Temporary Event Notices or variation applications.</p> <p>C. For the purpose of Clauses A and B above, the Core Hours for applications for each premises use type as defined within this policy are:</p> <ol style="list-style-type: none"> <li>1. <b>Casinos:</b> Up to 24 hours a day whilst casino gaming is permitted by a premises licence under the Gambling Act 2005.</li> <li>2. <b>Cinemas, Cultural Venues and Live Sporting Premises:</b> Monday to Sunday: 9am to 12am</li> <li>3. <b>Hotels:</b> Monday to Thursday: 9am to 11.30pm. Friday and Saturday: 9am to 12am. Sunday: 9am to 10.30pm. Sundays immediately prior to a bank holiday: 9am to 12am. For the sale of alcohol to guests for consumption in hotel/guest rooms only: Anytime up to 24 hours.</li> <li>4. <b>Off licences:</b> Monday to Saturday: 8am to 11pm. Sunday: 9am to 10.30pm.</li> <li>5. <b>Outdoor Spaces:</b> Monday to Thursday: 9am to 11.30pm. Friday and Saturday: 9am to 12am. Sunday: 9am to 10.30pm. Sundays immediately prior to a bank holiday: 9am to 12am.</li> <li>6. <b>Pubs and bars, Fast Food and Music and Dance venues:</b> Monday to Thursday: 10am to 11.30pm. Friday and Saturday: 10am to 12am. Sunday: 9am to 10.30pm. Sundays immediately prior to a bank holiday: 12pm to 12am.</li> <li>7. <b>Qualifying Clubs:</b> Monday to Thursday: 9am to 12am.. Friday and Saturday: 9am to 12am. Sunday: 9am to 10.30pm. Sundays immediately prior to a bank holiday: 9am to 12am.</li> <li>8. <b>Restaurants:</b> Monday to Thursday: 9am to 11.30pm. Friday and Saturday: 9am to 12am. Sunday: 9am to 10.30pm. Sundays immediately prior to a bank holiday: 9am to 12am.</li> <li>9. <b>Sexual Entertainment Venues and Sex Cinemas:</b> Monday to Thursday: 9am to 11.30pm. Friday and Saturday: 9am to 12am. Sunday: 9am to 10.30pm. Sundays immediately prior to a bank holiday: 9am to 12am.</li> </ol> <p>D. Core hours are when customers are permitted to be on the premises and therefore the maximum opening hours permitted will be to the same start and terminal hours for each of the days where licensable activity is permitted.</p> <p>E. For the purposes of this policy, 'premises uses' are defined within the relevant premises use policies within this statement.</p>
<p><b>Policy SHP1 applies</b></p>	<p>A. Applications for a shop outside the West End Cumulative Impact Zone will generally be granted subject to:</p> <ol style="list-style-type: none"> <li>1. The application meeting the requirements of policies CD1, PS1, PN1 and CH1.</li> <li>2. The hours for licensable activities are within the council's Core Hours Policy HRS1.</li> <li>3. The operation of any delivery services for alcohol meeting the council's Ancillary Alcohol and/or Late night Refreshment Delivery Service Policy DEL1.</li> <li>4. The applicant having taken account of the Special Consideration Zone Policy SCZ1 if the premises are located within a designated zone.</li> <li>5. The application and operation of the venue meeting the definition of a shop in Clause C.</li> </ol> <p>C. For the purposes of this policy:</p>

	<ol style="list-style-type: none"><li>1. A shop is defined as a stall, vehicle, vessel, temporary structure, building or part of a stall, vehicle, vessel, temporary structure or building where the primary activity is the sale of goods or services to customers upon payment.</li><li>2. The licensable activities for the sale of alcohol for consumption on the premises, regulated entertainment and/or late night refreshment must be ancillary to the primary use of the premises as a shop.</li><li>3. The licensable activity of the sale of alcohol for consumption off the premises must be an ancillary function to the primary use of the premises unless that primary use is to sell alcohol for consumption off the premises, e.g. a traditional off licence.</li></ol>
--	--

#### **4. Equality Implications**

The Council in its capacity as Licensing Authority has a duty to have regard to its public sector equality duty under section 149 of the Equality Act 2010. In summary, section 149 provides that a Public Authority must, in the exercise of its functions, have due regard to the need to:

- (a) eliminate discrimination harassment, victimisation and any other conduct that is prohibited by or under this Act;
- (b) advance equality of opportunity between persons who share a relevant protected characteristic and persons who do not share it; and
- (c) foster good relations between persons who share a relevant protected characteristics and persons who do not share it.

Section 149 (7) of the Equality Act 2010 defines the relevant protected characteristics as age, disability, gender reassignment, marriage and civil partnership, pregnancy and maternity, race, religion or belief, sex, and sexual orientation.

## 5. Appendices

<b>Appendix 1</b>	Premises plans
<b>Appendix 2</b>	Applicant supporting documents
<b>Appendix 3</b>	Temporary Event Notices history
<b>Appendix 4</b>	Proposed conditions
<b>Appendix 5</b>	Residential map and list of premises in the vicinity

<b>Report author:</b>	Miss Jessica Donovan Senior Licensing Officer
<b>Contact:</b>	Telephone: 020 7641 6500 Email: <a href="mailto:jdonovan@westminster.gov.uk">jdonovan@westminster.gov.uk</a>

**If you have any queries about this report or wish to inspect one of the background papers please contact the report author.**

### **Background Documents – Local Government (Access to Information) Act 1972**

<b>1</b>	Licensing Act 2003	N/A
<b>2</b>	City of Westminster Statement of Licensing Policy	01 October 2021
<b>3</b>	Amended Guidance issued under section 182 of the Licensing Act 2003	April 2018
<b>4</b>	Environmental Health Service representation <b><i>(Withdrawn 28<sup>th</sup> April 2022)</i></b>	27 April 2022
<b>5</b>	Interested party representation	26 April 2022

# No.13 Eccleston Yards Licencing Plan



E c c l e s t o n   Y a r d

**Legend**

- Fire alarm call point
- Smoke detector
- Fire exit, illuminated sign
- Fire alarm panel
- Emergency lighting
- Fire extinguisher

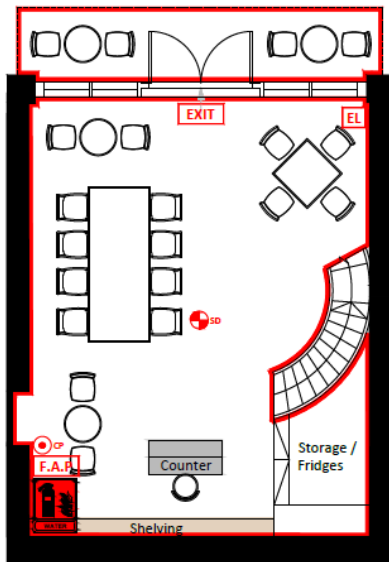

Ground Floor

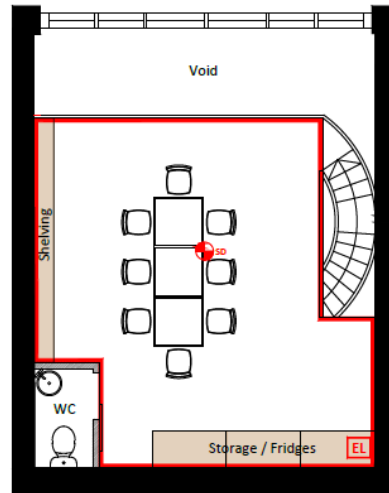

Mezzanine Floor

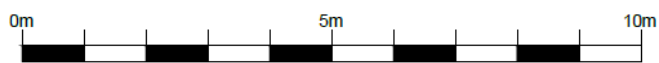

Scale 1:100 @ A4

21 Mar 22



**Applicants' mediation email**

**From:** Alun Thomas  
**To:** Donovan, Jessica: [REDACTED]  
**Subject:** 22/03444/LIPN - 13 Eccleston Yard - [GRO.14.15]  
**Date:** 12 May 2022 17:04:54

Jessica

Could this please be passed to the interested party.

[REDACTED]

The City Council have passed me a copy of your representation below as I act for the applicant. My client @Lindsey Harper would be more than happy to meet with you to address and allay your concerns but in the meantime, I hope the following will assist:

We are not aware of a licence rejection? Can you please provide more information so we can address?

This is a licence which would be time-limited for six months only

Could we arrange a time for [REDACTED] to meet/have a call with my client please?

Regards

**Alun Thomas**

Thomas & Thomas Partners LLP  
38a Monmouth Street  
London WC2H 9EP  
D: 020 7042 0412  
M: 07956 805464

W: <https://cas5-0-urlprotect.trendmicro.com:443/wis/clicktime/v1/query?url=www.tandtp.com&umid=fdc9ba6e-5f99-4287-bbbaea65500106b5&auth=f23bd3b3794c7a5914053bd0a99b1b4837b89b14-1d3b5bcff2a5b3d16829b0d28f86dd8e3522ca55>

Thomas & Thomas Partners LLP is a limited liability partnership registered in England and Wales (number OC363873) and regulated and authorised by the Solicitors Regulation Authority (number 561362). Its registered office is at 38a Monmouth Street, London WC2H 9EP. As this email and the information it contains are confidential and may be privileged, please notify us immediately if you have received this email in error. You should not copy it, or disclose its contents to any other person. We do not notify changes to important business information, such as bank account details, by email. If you are in any doubt as to the authenticity of this email, please see our note on cyber crime: [here](#).

**Temporary Event Notices History****Appendix 3**

<b>Application</b>	<b>Details of Application</b>	<b>Date Determined</b>	<b>Decision</b>
22/05342/LITENP	Temporary Event Notice	04.06.2022	Event allowed to proceed
22/05445/LITENP	Temporary Event Notice	27.05.2022	Event allowed to proceed
22/05447/LITENP	Temporary Event Notice	27.05.2022	Event allowed to proceed
22/05451/LITENP	Temporary Event Notice	27.05.2022	Event allowed to proceed

**CONDITIONS CONSISTENT WITH THE OPERATING SCHEDULE AND CONDITIONS PROPOSED BY A PARTY TO THE HEARING**

When determining an application for a new premises licence under the provisions of the Licensing Act 2003, the licensing authority must, unless it decides to reject the application, grant the licence subject to the conditions which are indicated as mandatory in this schedule.

At a hearing the licensing authority may, in addition, and having regard to any representations received, grant the licence subject to such conditions which are consistent with the operating schedule submitted by the applicant as part of their application, or alter or omit these conditions, or add any new condition to such extent as the licensing authority considers necessary for the promotion of the licensing objectives.

This schedule lists those conditions which are consistent with the operating schedule, or proposed as necessary for the promotion of the licensing objectives by a responsible authority or an interested party as indicated. These conditions have not been submitted by the licensing service but reflect the positions of the applicant, responsible authority or interested party and have not necessarily been agreed

**Mandatory Conditions**

1. No supply of alcohol may be made at a time when there is no designated premises supervisor in respect of this licence.
2. No supply of alcohol may be made at a time when the designated premises supervisor does not hold a personal licence or the personal licence is suspended.
3. Every supply of alcohol under this licence must be made or authorised by a person who holds a personal licence.
4.
  - (1) The responsible person must ensure that staff on relevant premises do not carry out, arrange or participate in any irresponsible promotions in relation to the premises.
  - (2) In this paragraph, an irresponsible promotion means any one or more of the following activities, or substantially similar activities, carried on for the purpose of encouraging the sale or supply of alcohol for consumption on the premises—
    - (a) games or other activities which require or encourage, or are designed to require or encourage, individuals to;
      - (i) drink a quantity of alcohol within a time limit (other than to drink alcohol sold or supplied on the premises before the cessation of the period in which the responsible person is authorised to sell or supply alcohol), or
      - (ii) drink as much alcohol as possible (whether within a time limit or otherwise);
    - (b) provision of unlimited or unspecified quantities of alcohol free or for a fixed or discounted fee to the public or to a group defined by a particular characteristic in a manner which carries a significant risk of undermining a licensing objective;
    - (c) provision of free or discounted alcohol or any other thing as a prize to encourage or reward the purchase and consumption of alcohol over a period of 24 hours or

less in a manner which carries a significant risk of undermining a licensing objective;

- (d) selling or supplying alcohol in association with promotional posters or flyers on, or in the vicinity of, the premises which can reasonably be considered to condone, encourage or glamorise anti-social behaviour or to refer to the effects of drunkenness in any favourable manner;
  - (e) dispensing alcohol directly by one person into the mouth of another (other than where that other person is unable to drink without assistance by reason of a disability).
5. The responsible person must ensure that free potable water is provided on request to customers where it is reasonably available.
6. (1) The premises licence holder or club premises certificate holder must ensure that an age verification policy is adopted in respect of the premises in relation to the sale or supply of alcohol.
- (2) The designated premises supervisor in relation to the premises licence must ensure that the supply of alcohol at the premises is carried on in accordance with the age verification policy.
- (3) The policy must require individuals who appear to the responsible person to be under 18 years of age (or such older age as may be specified in the policy) to produce on request, before being served alcohol, identification bearing their photograph, date of birth and either—
- (a) a holographic mark, or
  - (b) an ultraviolet feature.
7. The responsible person must ensure that—
- (a) where any of the following alcoholic drinks is sold or supplied for consumption on the premises (other than alcoholic drinks sold or supplied having been made up in advance ready for sale or supply in a securely closed container) it is available to customers in the following measures—
    - (i) beer or cider: ½ pint;
    - (ii) gin, rum, vodka or whisky: 25 ml or 35 ml; and
    - (iii) still wine in a glass: 125 ml;
  - (b) these measures are displayed in a menu, price list or other printed material which is available to customers on the premises; and
  - (c) where a customer does not in relation to a sale of alcohol specify the quantity of alcohol to be sold, the customer is made aware that these measures are available.

A responsible person in relation to a licensed premises means the holder of the premise licence in respect of the premises, the designated premises supervisor (if any) or any individual aged 18 or over who is authorised by either the licence holder or designated premises supervisor. For premises with a club premises certificate, any member or officer of the club present on the premises in a capacity that which enables him to prevent the supply of alcohol.

8(i) A relevant person shall ensure that no alcohol is sold or supplied for consumption on or off the premises for a price which is less than the permitted price.

8(ii) For the purposes of the condition set out in paragraph 8(i) above -

(a) "duty" is to be construed in accordance with the Alcoholic Liquor Duties Act 1979;

(b) "permitted price" is the price found by applying the formula -

$$P = D + (D \times V)$$

Where -

(i) P is the permitted price,

(ii) D is the amount of duty chargeable in relation to the alcohol as if the duty were charged on the date of the sale or supply of the alcohol, and

(iii) V is the rate of value added tax chargeable in relation to the alcohol as if the value added tax were charged on the date of the sale or supply of the alcohol;

(c) "relevant person" means, in relation to premises in respect of which there is in force a premises licence -

(i) the holder of the premises licence,

(ii) the designated premises supervisor (if any) in respect of such a licence, or

(iii) the personal licence holder who makes or authorises a supply of alcohol under such a licence;

(d) "relevant person" means, in relation to premises in respect of which there is in force a club premises certificate, any member or officer of the club present on the premises in a capacity which enables the member or officer to prevent the supply in question; and

(e) "value added tax" means value added tax charged in accordance with the Value Added Tax Act 1994.

8(iii). Where the permitted price given by Paragraph 8(ii)(b) above would (apart from this paragraph) not be a whole number of pennies, the price given by that sub-paragraph shall be taken to be the price actually given by that sub-paragraph rounded up to the nearest penny.

8(iv). (1) Sub-paragraph 8(iv)(2) below applies where the permitted price given by Paragraph 8(ii)(b) above on a day ("the first day") would be different from the permitted price on the next day ("the second day") as a result of a change to the rate of duty or value added tax.

(2) The permitted price which would apply on the first day applies to sales or supplies of alcohol which take place before the expiry of the period of 14 days beginning on the second day.

## Conditions consistent with the operating schedule

9. The licensable activities authorised by this licence and provided at the premises shall be ancillary to the main function of the premises as a Wine Shop.
10. A Challenge 25 proof of age scheme shall be operated at the premises where the only acceptable forms of identification are recognised photographic identification cards, such as a driving licence, passport or proof of age card with the PASS Hologram.
11. All sales of alcohol for consumption off the premises shall be in sealed containers only.
12. Patrons permitted to temporarily leave and then re-enter the premises, e.g. to smoke, shall not be permitted to take drinks or glass containers with them.
13. No noise generated on the premises, or by its associated plant or equipment, shall emanate from the premises nor vibration be transmitted through the structure of the premises which gives rise to a nuisance.
14. The approved arrangements at the premises, including means of escape provisions, emergency warning equipment, the electrical installation and mechanical equipment, shall at all material times be maintained in good condition and full working order.
15. No deliveries to the premises shall take place between 20.00 and 08.00 hours on the following day.
16. During the hours of operation of the premises, the licence holder shall ensure sufficient measures are in place to remove and prevent litter or waste arising or accumulating from customers in the area immediately outside the premises, and that this area shall be swept and or washed, and litter and sweepings collected and stored in accordance with the approved refuse storage arrangements by close of business.
17.
  - (a) The premises shall install and maintain a comprehensive CCTV system as per the minimum requirements of the Westminster Police Licensing Team.
  - (b) All entry and exit points will be covered enabling frontal identification of every person entering in any light condition.
  - (c) The CCTV system shall continually record whilst the premises is open for licensable activities and during all times when customers remain on the premises and will include the external area immediately outside the premises entrance.
  - (d) All recordings shall be stored for a minimum period of 31 days with date and time stamping.
  - (e) Viewing of recordings shall be made available immediately upon the request of Police or authorised officer throughout the entire 31-day period.
18. A staff member from the premises who is conversant with the operation of the CCTV system shall be on the premises at all times when the premises is open. This staff member must be able to provide a Police or authorised council officer copies of recent CCTV images or data with the absolute minimum of delay when requested.
19. There shall be no sales of alcohol for consumption off the premises after 22:00 hours.
20. All tills shall automatically prompt staff to ask for age verification identification when presented with an alcohol sale.

21. No super-strength beer, lagers, ciders or spirit mixtures of 5.5% ABV (alcohol by volume) or above shall be sold at the premises, except for premium beers and ciders supplied in glass bottles and cans.
22. The supply of alcohol shall be by waiter or waitress service only.
23. A Challenge 21 or Challenge 25 proof of age scheme shall be operated at the premises where the only acceptable forms of identification are recognised photographic identification cards, such as a driving licence, passport or proof of age card with the PASS Hologram.
24. An incident log shall be kept at the premises, and made available on request to an authorised officer of the City Council or the Police. It must be completed within 24 hours of the incident and will record the following:
  - (a) all crimes reported to the venue
  - (b) all ejections of patrons
  - (c) any complaints received concerning crime and disorder
  - (d) any incidents of disorder
  - (e) all seizures of drugs or offensive weapons
  - (f) any faults in the CCTV system
  - (g) any refusal of the sale of alcohol
  - (h) any visit by a relevant authority or emergency service.
25. A direct telephone number for the manager at the premises shall be publicly available at all times the premises is open. This telephone number is to be made available to residents and businesses in the vicinity.
26. Before the premises open to the public, the plans as deposited (or subsequently substituted plans) will be checked by the Environmental Health Consultation Team to ensure they are an accurate reflection of the premises constructed. Where the premises layout has changed during the course of construction new plans shall be provided to the Environmental Health Consultation Team and the Licensing Authority.
27. No licensable activities shall take place at the premises until the works have been assessed as satisfactory by the Environmental Health Consultation Team at which time this condition shall be removed from the Licence by the licensing authority.
28. No licensable activities shall take at the premises until the capacity of the premises has been determined by the Environmental Health Consultation Team and the licensing authority has replaced this condition on the licence with a condition detailing the capacity so determined.

### **Conditions proposed by the Environmental Health**

None



**Resident Count: 147**



**Licensed premises within 75 metres of 13 Eccleston Yard, City Of Westminster, London, SW1W 9AZ**

<b>Licence Number</b>	<b>Trading Name</b>	<b>Address</b>	<b>Premises Type</b>	<b>Time Period</b>
18/06841/LIPN	50M	14 - 15 Eccleston Yard City Of Westminster London SW1W 9AZ	Shop	Sunday; 11:00 - 18:30   Monday to Wednesday; 11:00 - 19:30   Thursday to Saturday; 11:00 - 23:30   Sundays before Bank Holidays; 11:00 - 23:30
21/11166/LIPN	Biscuiteer	14 - 15 Eccleston Yard City Of Westminster London SW1W 9AZ	Restaurant	Monday to Sunday; 10:00 - 18:00
19/14691/LIPN	Not Recorded	10 Eccleston Yard City Of Westminster London SW1W 9AZ	Restaurant	Monday to Sunday; 08:00 - 00:00
21/07860/LIPT	Eccleston Yards	7 - 8 Eccleston Yard City Of Westminster London SW1W 9AZ	Restaurant	Monday; 10:00 - 23:30   Tuesday; 10:00 - 23:30   Wednesday; 10:00 - 23:30   Thursday; 10:00 - 00:00   Friday; 10:00 - 00:00   Saturday; 10:00 - 00:00   Sunday; 11:00 - 22:30
18/16194/LIPDPS	Not Recorded	11 - 19 Eccleston Place London SW1W 9NF	Restaurant	Sunday; 12:00 - 22:30   Monday to Thursday; 10:00 - 23:30   Friday to Saturday; 10:00 - 00:00   Sundays before Bank Holidays; 12:00 - 00:00
20/05941/LIPDPS	Not Recorded	1 - 2 Eccleston Yard City Of	Miscellaneous	Monday to Sunday; 07:00

		Westminster London SW1W 9NF		- 00:00
21/11371/LIPT	Batonnage Wine Bar	23 Eccleston Place London SW1W 9NF	Cafe	Sunday; 10:00 - 21:30   Monday to Saturday; 10:00 - 23:00
21/01085/LIPDPS	Sainsburys	14 - 20 Elizabeth Street London SW1W 9RB	Food store	Monday to Sunday; 00:00 - 00:00
21/05817/LIPDPS	Lime Tree Hotel	135 - 137 Ebury Street London SW1W 9QU	Guest or boarding house	Monday to Sunday; 00:00 - 00:00
22/04517/LIPDPS	Travellers Tavern	4 Elizabeth Street London	Public house or pub restaurant	Sunday; 07:00 - 22:50   Sunday; 07:00 - 22:50   Monday to Thursday; 07:00 - 23:30   Monday to Saturday; 07:00 - 00:30   Friday to Saturday; 07:00 - 00:00   Sundays before Bank Holidays; 07:00 - 00:00   Sundays before Bank Holidays; 07:00 - 00:00