



City of Westminster

# Licensing Sub-Committee Report

Item No:

Date:

13 June 2024

Licensing Ref No:

24/01504/LIPN - New Premises Licence

Title of Report:

Basement And Ground Floor  
353 Harrow Road  
London  
W9 3NA

Report of:

Director of Public Protection and Licensing

Wards involved:

Harrow Road

Policy context:

City of Westminster Statement of Licensing Policy

Financial summary:

None

Report Author:

Karyn Abbott  
Senior Licensing Officer

Contact details

Telephone: 020 7641 6500  
Email: [kabbott@westminster.gov.uk](mailto:kabbott@westminster.gov.uk)

## 1. Application

1-A Applicant and premises			
<b>Application Type:</b>	New Premises Licence, Licensing Act 2003		
<b>Application received date:</b>	13 March 2024		
<b>Applicant:</b>	Mr Grover Paranjeet Singh		
<b>Premises:</b>	N/A		
<b>Premises address:</b>	Basement And Ground Floor 353 Harrow Road London W9 3NA	<b>Ward:</b>	Harrow Road
		<b>Cumulative Impact Area:</b>	None
		<b>Special Consideration Zone:</b>	None
<b>Premises description:</b>	According to the application form the premises proposes to operate as an Off Licence and Convenience Store.		
<b>Premises licence history:</b>	This is a new premises licence application and therefore no premises licence history exists.		
<b>Applicant submissions:</b>	<p>The applicant proposed conditions in their operating schedule and has agreed a number of conditions with the Metropolitan Police.</p> <p>These can be found in <b>Appendix 4</b>.</p>		
<b>Applicant amendments:</b>	None		

1-B Proposed licensable activities and hours							
<b>Sale by retail of alcohol</b>				<b>On or off sales or both:</b>			Off
<b>Day:</b>	<b>Mon</b>	<b>Tues</b>	<b>Wed</b>	<b>Thur</b>	<b>Fri</b>	<b>Sat</b>	<b>Sun</b>
<b>Start:</b>	08:00	08:00	08:00	08:00	08:00	08:00	09:00
<b>End:</b>	23:00	23:00	23:00	23:00	23:00	23:00	22:30
<b>Seasonal variations/ Non-standard timings:</b>		None					

Hours premises are open to the public							
<b>Day:</b>	<b>Mon</b>	<b>Tues</b>	<b>Wed</b>	<b>Thur</b>	<b>Fri</b>	<b>Sat</b>	<b>Sun</b>
<b>Start:</b>	08:00	08:00	08:00	08:00	08:00	08:00	08:00
<b>End:</b>	23:00	23:00	23:00	23:00	23:00	23:00	23:00
<b>Seasonal variations/ Non-standard timings:</b>		None					
<b>Adult Entertainment:</b>		None					

## 2. Representations

2-A Responsible Authorities	
<b>Responsible Authority:</b>	Environmental Health Service
<b>Representative:</b>	Anil Drayan
<b>Received:</b>	10 April 2024
<p>Representations made as insufficient information has been provided and the proposal may therefore undermine the licensing objectives of Public Nuisance, Public Safety and Prevention of Harm to Children</p> <p>The applicant is requested to contact the undersigned to discuss the application after which additional may be proposed:</p>	
<b>Responsible Authority:</b>	Metropolitan Police Service
<b>Representative:</b>	PC Dave Morgan
<b>Received:</b>	10 April 2024 ( <b>Withdrawn 1<sup>st</sup> May 2024</b> )
<p>Dear Mr Kapoor,</p> <p>Re: Application for a New Premise Licence: Sunny Corner, 353 Harrow Road, London, W9 3NA - 24/01504/LIPN.</p> <p>With regards to the above, the Metropolitan Police Service as a Responsible Authority are <b>objecting</b> to this application on the basis that there is insufficient detail contained within the operating schedule in order to promote the Licensing Objectives, namely the Prevention of Crime and Disorder and the Protection of Children from Harm.</p> <p>The applicant is seeking:</p> <p style="padding-left: 40px;"><b>Supply of Alcohol (off sales)</b> Mon-Sat: 0800 – 2300. Sun: 0900 – 2230</p> <p style="padding-left: 40px;"><b>Opening Hours:</b> Mon-Sun: 0800 – 2300</p> <p>I note that the venue is not situated within any of the Westminster Councils Cumulative Impact or Special Consideration Zones, and the hours are within the Westminster Councils Core Hours policy.</p> <p>I also appreciate that you have offered a number of conditions to help promote the Licensing Objectives within the operating schedule, but I feel that there may be more conditions that we would like to see added to the licence should it be granted.</p> <p>To move forward, I have attached a list of conditions to this email that the Police would like to see added to the licence should it be granted.</p> <p>Please have a read and let me know your thoughts.</p> <p><b>The Metropolitan Police withdrew their representation on the 1<sup>st</sup> May 2024 due to the reduction conditions that were agreed with the applicant. These can be found at Appendix 4.</b></p>	

<b>2-B Other Persons</b>			
<b>Name:</b>		[REDACTED]	
<b>Address and/or Residents Association:</b>		[REDACTED]	
<b>Status:</b>	Valid	<b>In support or objection:</b>	OBJECTION
<b>Received:</b>	8 Apr 2024		

I am emailing to express my opposition to the following application:  
 24/01504/LIPN | Premises Licence - New | Pending Decision | Basement And Ground Floor 353 Harrow Road London W9 3NA

[REDACTED]

Within 50 meters of site of application, SUNNY CORNER, 353 HARROW ROAD, LONDON, W9 3NA, there are 5 shops which sell alcohol: one directly neighbouring, three on Great Western Road and one across the street 'Sainsbury's'. Within 75 meters there are two additional, Coop & Iceland. There is no need for an additional shop. Adding another would flood the market, detrimental to these other shops and prevent the opportunity for an alternative business to set up.

This Harrow Road junction has previously been identified of an area of anti-social behaviour. For example large groups drink in the market as well as in front of Sainsbury's. If the proposed license is permitted then this could be contributing to the concern.

Diversity of shops on Harrow Road is a council aim as well as a request by local residents during the recent consultation. If the proposed license is permitted then this would be a direct act against both. This would call to question whether council goals & consultation is genuine and to set to truly make the area better in terms of health & safety.

I point out the emphasis of the late night hours on the application. What is needed is daytime services as identified in the Mayor's creative zone for the area. Workers in the area need of services to facilitate working ie daytime shopping & services such as lunches & printers.

I hope this opposition will be considered and I look forward to confirmation that it has been received.

<b>Name:</b>		[REDACTED]	
<b>Address and/or Residents Association:</b>		[REDACTED]	
<b>Status:</b>	Valid	<b>In support or objection:</b>	OBJECTION
<b>Received:</b>	10 April 2024		

I work in this area and there is a lot of alcohol related antisocial behaviour at this junction. My clients feel unsafe , and so do I. Basically, selling more alcohol will not help the many victims of alcoholism in this neighbourhood. There is already a wine merchant 2 doors away and an off licence another two doors away. That's already two shops selling alcohol on the same block. Adding a third is just mindless. The council states that is is fixing up the space across the street specifically to address anti-social behaviour, therefore it will be a conflict of interest to grant this license. Please support the shop in finding a better use for the premises that complement the council community engagement project across the street.

<b>Name:</b>		[REDACTED]	
<b>Address and/or Residents Association:</b>		[REDACTED] [REDACTED] [REDACTED] [REDACTED]	
<b>Status:</b>	Valid	<b>In support or objection:</b>	OBJECTION
<b>Received:</b>	10 April 2024		

Myself and many neighbours and Champers didn't receive any notices we were told yesterday. Looking at a video.their notice was hidden by vapes posters none was .displayed on the shutter facing Harrow Rd or on the shutter facing Great Western Rd I believe that we don't need another off-licence. We have 3. [REDACTED] 12 Great Western.Rd Champers.6 Great Western Rd.W W9.355.Harrow.Rd.and.they are next door 353 Harrow Rd..The Antisocial spot because of the mobile phone shop.outside 355.from children to adults hanging around waiting for phones.to be fixed and these new people at 353.who ia applying for licence selling special price vapes. We are all ready struggling our business is affected because the .other 2 stores are in competition because their business is ok as they sell high strength beers.and guinness and they are allowed to sell single bottles and cans ...So another off-licence next door next-door to.355the troubled spot.and.in such close proximity is not really necessary. I highly object to the granting of this off-licence .

<b>Name:</b>		[REDACTED]	
<b>Address and/or Residents Association:</b>		[REDACTED] [REDACTED] [REDACTED] [REDACTED]	
<b>Status:</b>	Valid	<b>In support or objection:</b>	OBJECTION
<b>Received:</b>	10 April 2024		

My self and many neighbours didn't receive any notice .It was a shock yesterday when a neighbour.told us that the hair dresser/Caffè A VAPE.SHOP selling selling special offer vapes is applying for off-licence

<b>Name:</b>		[REDACTED]	
<b>Address and/or Residents Association:</b>		[REDACTED]	
<b>Status:</b>	Valid	<b>In support or objection:</b>	OBJECTION
<b>Received:</b>	9 Apr 2024		

[REDACTED]  
[REDACTED] I strongly feel that there is no need for an additional shop selling alcohol on in the neighbourhood, considering there are 5 shops in the near vicinity that provide this service. I believe that adding another would flood the market, detrimental to other shops and preventing the opportunity for an alternative business to set up.

This Harrow Road junction has previously been identified of an area of anti-social behaviour. For example large groups drink in the market as well as in front of Sainsbury's. If the proposed license is permitted then this could be contributing to the concern.

Diversity of shops on Harrow Road is a council aim as well as a request by local residents during the recent consultation. If the proposed license is permitted then this would be a direct act against both. This would call to question whether council goals & consultation is genuine and to set to truly make the area better in terms of health & safety.

I point out the emphasis of the late night hours on the application. What is needed is daytime

services as identified in the Mayor's creative zone for the area. Workers in the area need of services to facilitate working ie daytime shopping & services such as lunches & printers.

I hope this opposition will be considered and I look forward to confirmation that it has been received.

<b>Name:</b>	[REDACTED]		
<b>Address and/or Residents Association:</b>	[REDACTED] [REDACTED] [REDACTED]		
<b>Status:</b>	Valid	<b>In support or objection:</b>	OBJECTION
<b>Received:</b>	7 April 2024		

I firmly object to this application.

This stretch of Harrow Road including Maida Hill Place already faces well known issues with ASB partially linked to alcohol consumption and including public urinating, drug and alcohol use in the public space, catcalling, fly tipping.

The new regeneration project involving the square will also aim at eradicating these issues. Allowing the proposed licence would go the opposite direction in that it will certainly not help with the above issues but rather contribute to their prolonging.

One additional store selling alcohol is certainly not needed but rather it has to be avoided.

<b>Name:</b>	[REDACTED]		
<b>Address and/or Residents Association:</b>	[REDACTED] [REDACTED] [REDACTED]		
<b>Status:</b>	Valid	<b>In support or objection:</b>	OBJECTION
<b>Received:</b>	9 April 2024		

[REDACTED] really don't feel another off licence is needed at all, as there is already Nisa West 9 directly next door, also Champers and Maida Hill Food & Wine plus Sainsburys, Co-op and other off licences down the Harrow Road which is more than sufficient enough. There is already a local problem across in the market with people gathering all day every day drinking etc and I feel another off licence directly across from there is not needed.

<b>Name:</b>	[REDACTED]		
<b>Address and/or Residents Association:</b>	[REDACTED] [REDACTED] [REDACTED]		
<b>Status:</b>	Valid	<b>In support or objection:</b>	OBJECTION
<b>Received:</b>	10 April 2024		

Maida Hill and this single block of the road already has a huge number of convenience stores, off licences and other mini-market/locations to buy alcohol. The number in such a small distance is already crazy, and the area definitely does not need more.

There are already 5 commercial businesses within 20 metre radius of the address that already sell alcohol... Literally next door to this address on Harrow Road there is Smokers Junction. The 5 neighbouring buildings down Great Western Road of this address there is already Great Western Food and Wine and Champers Wine. Sainsbury's and COOP across the road.

Looking at mini-markets and convenience stores there are a dozen more.

There is a huge issue with alcoholism, antisocial drinking, public urination and other alcohol related antisocial behaviour in the area and another shop selling discount alcohol 24hrs a day is only going to further this problem and continue to spoil the area.

There is a lot of chat from the council about regenerating the area and the plans for the market regeneration but what is the point in doing this if you continually enable the entire area to become off licences, chicken shops and discount stores.

### 3. Policy & Guidance

The following policies within the City Of Westminster Statement of Licensing Policy apply:

<b>Policy HRS1 applies</b>	<p>A. Applications within the core hours set out below in this policy will generally be granted for the relevant premises uses, subject to not being contrary to other policies in the Statement of Licensing Policy.</p> <p>B. Applications for hours outside the core hours set out in Clause C will be considered on their merits, subject to other relevant policies, and with particular regard to the following:</p> <ol style="list-style-type: none"><li>1. The demonstration of compliance in the requirements of policies CD1, PS1, PN1 and CH1 associated with the likelihood of the effect of the grant of a licence for later or earlier hours on crime and disorder, public safety, public nuisance and the protection of children from harm.</li><li>2. If the application is located within a Special Consideration Zone they have demonstrated that they have taken account of the issues identified in that area and provided adequate mitigation.</li><li>3. Whether there is residential accommodation in the proximity of the premises that would likely be adversely affected by premises being open or carrying out operations at the hours proposed.</li><li>4. The proposed hours of the licensable activities and when customers will be permitted to remain on the premises.</li><li>5. The proposed hours when any music, including incidental music, will be played.</li><li>6. The hours when customers will be allowed to take food or drink outside the premises or be within open areas which form part of the premises.</li><li>7. The existing hours of licensable activities and the past operation of the premises (if any) and hours of licensable premises in the vicinity.</li><li>8. Whether customers and staff have adequate access to public transport when arriving at and leaving the premises, especially at night.</li><li>9. The capacity of the premises.</li><li>10. The type of use, recognising that some venues are more likely to impact the licensing objectives than others; for example, pubs and bars are higher risk than theatres, cinemas and other cultural and sporting venues due to the nature of the operation.</li><li>11. The Licensing Authority will take into account the active measures proposed for a 'winding down' period including arrangements for people to be collected from the premises to travel home safely.</li><li>12. Conditions on hours may be attached that require that the supply of alcohol for consumption on the premises ceases a suitable period of time before customers are required to leave the premises.</li><li>13. The council, acting as the Licensing Authority, may reduce hours</li></ol>
----------------------------	--

	<p>if, after review, it is necessary to impose conditions specifying shorter hours in order to promote the licensing objectives.</p> <p>14. Specific days for non-standard hours should be identified and justified as part of the application to allow responsible authorities and interested parties to evaluate the impact that these licensable activities may have, and to plan accordingly. The consideration of applications for later hours for Bank Holiday Mondays will take into account that later hours are generally granted for preceding Sundays and that the next day is a working day. Non-specific days are expected to be covered by Temporary Event Notices or variation applications.</p> <p>C. For the purpose of Clauses A and B above, the Core Hours for this application for each premises use type as defined within this policy are:</p> <p><b>11a. Shops (all licensable activities that are provided as ancillary to the primary use of the premises as a shop except the off sale of alcohol)</b></p> <p>Monday to Thursday: 9am to 11.30pm.  Friday and Saturday: 9am to Midnight.  Sunday: 9am to 10.30pm.  Sundays immediately prior to a bank holiday: 9am to Midnight.</p> <p><b>11b. Shops (off-sales of alcohol where it forms either the ancillary or primary use of the premises)</b></p> <p>Monday to Saturday: 8am to 11pm.  Sunday: 9am to 10.30pm.</p>
<p><b>Policy SHP1 applies</b></p>	<p>A. Applications for a shop outside the West End Cumulative Impact Zone will generally be granted subject to:</p> <ol style="list-style-type: none"> <li>1. The application meeting the requirements of policies CD1, PS1, PN1 and CH1.</li> <li>2. The hours for licensable activities are within the council's Core Hours Policy HRS1.</li> <li>3. The operation of any delivery services for alcohol meeting the council's Ancillary Alcohol and/or Latenight Refreshment Delivery Service Policy DEL1.</li> <li>4. The applicant having taken account of the Special Consideration Zone Policy SCZ1 if the premises are located within a designated zone.</li> <li>5. The application and operation of the venue meeting the definition of a shop in Clause C.</li> </ol> <p>B. Applications for a shop inside the West End Cumulative Impact Zone will be considered on their own merits and subject to:</p> <ol style="list-style-type: none"> <li>1. The application meeting the requirements of policies CD1, PS1, PN1 and CH1.</li> <li>2. The hours for licensable activities are within the council's Core Hours Policy HRS1.</li> <li>3. The operation of any delivery services for alcohol meeting the council's Ancillary Alcohol and/or Latenight Refreshment Delivery Service Policy DEL1.</li> <li>4. The applicant having demonstrated that they will not add to cumulative impact within the Cumulative Impact Zone.</li> <li>5. The application and operation of the venue meeting the definition of a shop in Clause C.</li> </ol> <p>C. For the purposes of this policy:</p>



	<p>1. A shop is defined as a stall, vehicle, vessel, temporary structure, building or part of a stall, vehicle, vessel, temporary structure or building where the primary activity is the sale of goods or services to customers upon payment.</p> <p>2. The licensable activities for the sale of alcohol for consumption on the premises, regulated entertainment and/or late night refreshment must be ancillary to the primary use of the premises as a shop.</p> <p>3. The licensable activity of the sale of alcohol for consumption off the premises must be an ancillary function to the primary use of the premises unless that primary use is to sell alcohol for consumption off the premises, e.g. a traditional off licence.</p>
--	---

#### 4. Equality Implications

The Council in its capacity as Licensing Authority has a duty to have regard to its public sector equality duty under section 149 of the Equality Act 2010. In summary, section 149 provides that a Public Authority must, in the exercise of its functions, have due regard to the need to:

- (a) eliminate discrimination harassment, victimisation and any other conduct that is prohibited by or under this Act;
- (b) advance equality of opportunity between persons who share a relevant protected characteristic and persons who do not share it; and
- (c) foster good relations between persons who share a relevant protected characteristics and persons who do not share it.

Section 149 (7) of the Equality Act 2010 defines the relevant protected characteristics as age, disability, gender reassignment, marriage and civil partnership, pregnancy and maternity, race, religion or belief, sex, and sexual orientation.

#### 5. Appendices

<b>Appendix 1</b>	Premises plans
<b>Appendix 2</b>	Applicant supporting documents
<b>Appendix 3</b>	Premises history
<b>Appendix 4</b>	Proposed conditions
<b>Appendix 5</b>	Residential map and list of premises in the vicinity

<b>Report author:</b>	Karyn Abbott Senior Licensing Officer
<b>Contact:</b>	Telephone: 020 7641 6500 Email: kabbott@westminster.gov.uk

**If you have any queries about this report or wish to inspect one of the background papers please contact the report author.**

**Background Documents – Local Government (Access to Information) Act 1972**

<b>1</b>	Licensing Act 2003	N/A
<b>2</b>	City of Westminster Statement of Licensing Policy	01 October 2021
<b>3</b>	Amended Guidance issued under section 182 of the Licensing Act 2003	December 2023
<b>4</b>	Cumulative Impact Assessment	04 December 2023
<b>5</b>	Environmental Health Service	10 April 2024
<b>6</b>	Metropolitan Police Service ( <b>Withdrawn 1<sup>st</sup> May 2024</b> )	10 April 2024
<b>7</b>	Representation 1	8 April 2024
<b>8</b>	Representation 2	10 April 2024
<b>9</b>	Representation 3	10 April 2024
<b>10</b>	Representation 4	10 April 2024
<b>11</b>	Representation 5	9 April 2024
<b>12</b>	Representation 6	7 April 2024
<b>13</b>	Representation 7	9 April 2024
<b>14</b>	Representation 8	10 April 2024

# PROPOSED LICENCE PLAN

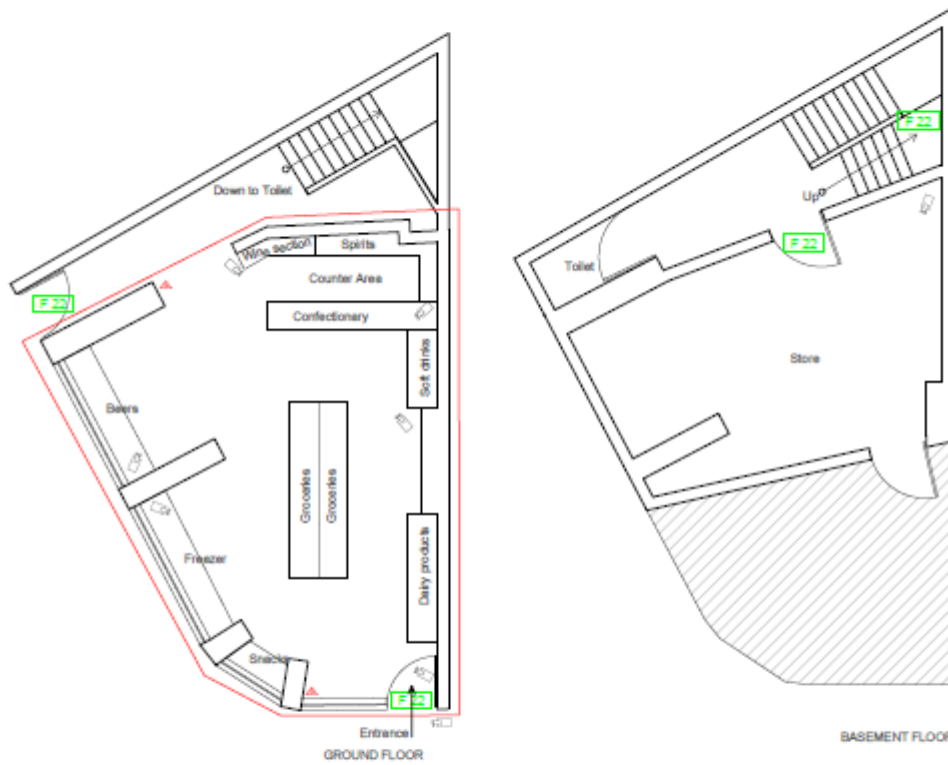

Property Address:  
 Sunny's Corner  
 353 Harrow Road  
 Maida Hill,  
 W9 3NA

Drawing No. AC021		Date: 12/03/24
Key	Scale : 1:100	Paper : A4
	Fire Extinguisher	
	Fire Exit Signs	
	CCTV Cameras	
	Licensable Area	
CCTV Recordings 31 Days		

**Applicant Supporting Documents**

**Appendix 2**

None

## **Premises History**

## **Appendix 3**

There is no licence or appeal history for the premises.

**CONDITIONS CONSISTENT WITH THE OPERATING SCHEDULE AND CONDITIONS PROPOSED BY A PARTY TO THE HEARING**

When determining an application for a new premises licence under the provisions of the Licensing Act 2003, the licensing authority must, unless it decides to reject the application, grant the licence subject to the conditions which are indicated as mandatory in this schedule.

At a hearing the licensing authority may, in addition, and having regard to any representations received, grant the licence subject to such conditions which are consistent with the operating schedule submitted by the applicant as part of their application, or alter or omit these conditions, or add any new condition to such extent as the licensing authority considers necessary for the promotion of the licensing objectives.

This schedule lists those conditions which are consistent with the operating schedule, or proposed as necessary for the promotion of the licensing objectives by a responsible authority or an interested party as indicated. These conditions have not been submitted by the licensing service but reflect the positions of the applicant, responsible authority or interested party and have not necessarily been agreed

**Mandatory Conditions**

1. No supply of alcohol may be made at a time when there is no designated premises supervisor in respect of this licence.
2. No supply of alcohol may be made at a time when the designated premises supervisor does not hold a personal licence or the personal licence is suspended.
3. Every supply of alcohol under this licence must be made or authorised by a person who holds a personal licence.
4.
  - (1) The premises licence holder or club premises certificate holder must ensure that an age verification policy is adopted in respect of the premises in relation to the sale or supply of alcohol.
  - (2) The designated premises supervisor in relation to the premises licence must ensure that the supply of alcohol at the premises is carried on in accordance with the age verification policy.
  - (3) The policy must require individuals who appear to the responsible person to be under 18 years of age (or such older age as may be specified in the policy) to produce on request, before being served alcohol, identification bearing their photograph, date of birth and either—
    - (a) a holographic mark, or
    - (b) an ultraviolet feature.
- 5(i) A relevant person shall ensure that no alcohol is sold or supplied for consumption on or off the premises for a price which is less than the permitted price.
- 5(ii) For the purposes of the condition set out in paragraph 5(i) above -
  - (a) "duty" is to be construed in accordance with the Alcoholic Liquor Duties Act

1979;

(b) "permitted price" is the price found by applying the formula -

$$P = D + (D \times V)$$

Where -

- (i) P is the permitted price,
- (ii) D is the amount of duty chargeable in relation to the alcohol as if the duty were charged on the date of the sale or supply of the alcohol, and
- (iii) V is the rate of value added tax chargeable in relation to the alcohol as if the value added tax were charged on the date of the sale or supply of the alcohol;

(c) "relevant person" means, in relation to premises in respect of which there is in force a premises licence -

- (i) the holder of the premises licence,
- (ii) the designated premises supervisor (if any) in respect of such a licence, or
- (iii) the personal licence holder who makes or authorises a supply of alcohol under such a licence;

(d) "relevant person" means, in relation to premises in respect of which there is in force a club premises certificate, any member or officer of the club present on the premises in a capacity which enables the member or officer to prevent the supply in question; and

(e) "value added tax" means value added tax charged in accordance with the Value Added Tax Act 1994.

5(iii). Where the permitted price given by Paragraph 5(ii)(b) above would (apart from this paragraph) not be a whole number of pennies, the price given by that sub-paragraph shall be taken to be the price actually given by that sub-paragraph rounded up to the nearest penny.

5(iv). (1) Sub-paragraph 5(iv)(2) below applies where the permitted price given by Paragraph 5(ii)(b) above on a day ("the first day") would be different from the permitted price on the next day ("the second day") as a result of a change to the rate of duty or value added tax.

(2) The permitted price which would apply on the first day applies to sales or supplies of alcohol which take place before the expiry of the period of 14 days beginning on the second day.

### **Conditions consistent with the operating schedule**

6. All goods, including those subject to duty payments i.e. alcohol and tobacco products will be brought from cash and carries only on invoices and they will be available upon request. All alcohol will be purchased from AWRS registered cash & carry or wholesalers.

7. All staff to be trained every 6 months in relation to licensing objectives and making sure they are promoted properly.

8. Notice displayed asking customers to leave quietly from premises also customers will be told in person to leave quietly and not to disturb the local neighbourhood.
9. A sign stating "No proof of age – No sale" shall be displayed at the point of sale.

**Conditions proposed by the Police and agreed with the applicant to form part of the operating schedule**

10. The premises shall install and maintain a comprehensive CCTV system as per the minimum requirements of the Westminster Police Licensing Team. All entry and exit points will be covered enabling frontal identification of every person entering in any light condition. The CCTV system shall continually record whilst the premises is open for licensable activities and during all times when customers remain on the premises and will include the external area immediately outside the premises entrance. All recordings shall be stored for a minimum period of 31 days with date and time stamping. Viewing of recordings shall be made available immediately upon the request of Police or authorised officer throughout the entire 31-day period.
11. A staff member from the premises who is conversant with the operation of the CCTV system shall be on the premises at all times when the premises is open. This staff member must be able to provide a Police or authorised council officer copies of recent CCTV images or data with the absolute minimum of delay when requested.
12. There shall be no sales of alcohol for consumption off the premises after 23.00 hours.
13. All sales of alcohol for consumption off the premises shall be in sealed containers only, and shall not be consumed on the premises.
14. A direct telephone number for the manager at the premises shall be publicly available at all times the premises is open. This telephone number and/or is to be made available to residents and businesses in the vicinity.
15. Outside of the hours authorised for the sale of alcohol and whilst the premises are open to the public, the licence holder shall ensure that all alcohol within the premises (including alcohol behind the counter) is secured in a locked store room or behind locked grilles, locked screens or locked cabinet doors so as to prevent access to the alcohol by both customers and staff.
16. No super-strength beer, lagers, ciders or spirit mixtures of 5.5% ABV (alcohol by volume) or above shall be sold at the premises, except for premium beers and ciders supplied in glass bottles and cans.
17. No more than 15% of the sales area shall be used at any one time for the sale, exposure for sale, or display of alcohol.
18. There shall be no self-selection of spirits on the premises, save for spirit mixtures less than 5.5% ABV.
19. Prominent signage indicating the permitted hours for the sale of alcohol shall be displayed so as to be visible before entering the premises, where alcohol is on public display, and at the point of sale.
20. A Challenge 25 proof of age scheme shall be operated at the premises where the only acceptable forms of identification are recognised photographic identification cards, such as a driving licence, passport or proof of age card with the PASS Hologram.



21. A record shall be kept detailing all refused sales of alcohol. The record should include the date and time of the refused sale and the name of the member of staff who refused the sale. The record shall be available for inspection at the premises by the police or an authorised officer of the City Council at all times whilst the premises is open.
22. An incident log shall be kept at the premises, and made available on request to an authorised officer of the City Council or the Police. It must be completed within 24 hours of the incident and will record the following:
  - (a) all crimes reported to the venue
  - (b) all ejections of patrons
  - (c) any complaints received concerning crime and disorder
  - (d) any incidents of disorder
  - (e) all seizures of drugs or offensive weapons
  - (f) any faults in the CCTV system, searching equipment or scanning equipment
  - (g) any refusal of the sale of alcohol
  - (h) any visit by a relevant authority or emergency service.
23. No miniature bottles of spirits of 20 cl or below shall be sold from the premises.
24. All tills shall automatically prompt staff to ask for age verification identification when presented with an alcohol sale.

**Conditions proposed by the Environmental Health**

None

353 Harrow Road, London

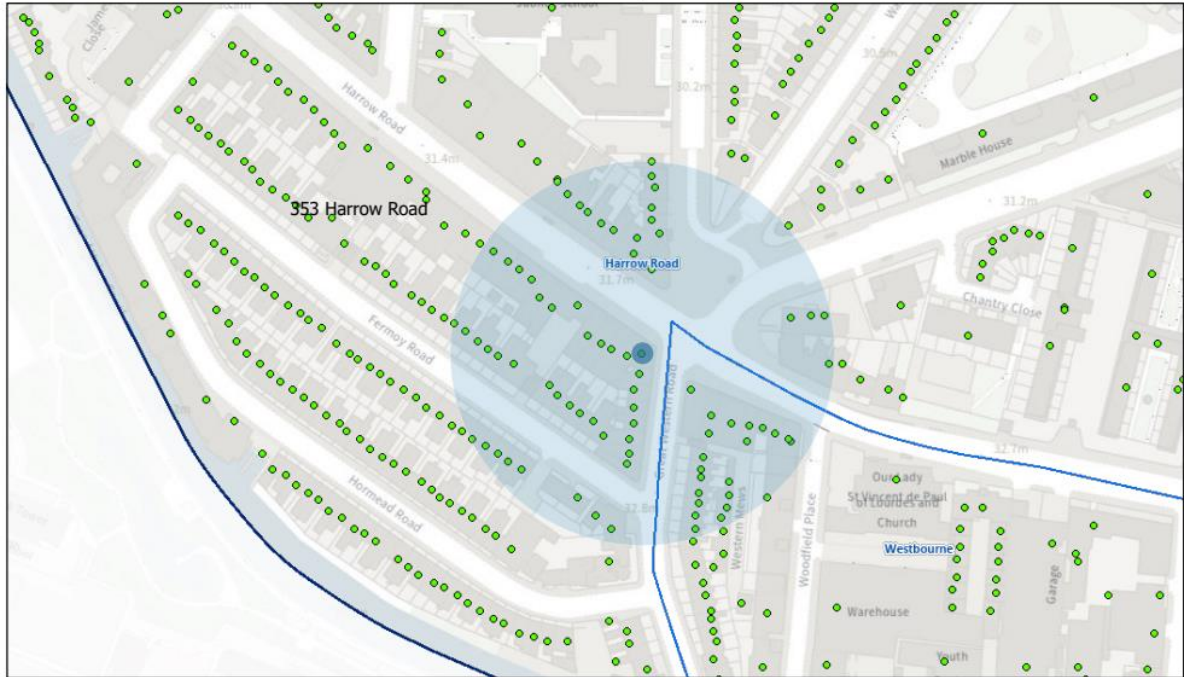

31/05/2024, 12:28:04

- Property Mailing List
- Ward Labels
- Borough Boundary - Mask
- Borough Boundary - Detailed
- Ward Boundaries

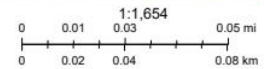

**Resident Count: 301**

Licensed premises within 75m of Basement And Ground Floor				
Licence Number	Trading Name	Address	Premises Type	Time Period
15/00547/LIPVM	W9 Food And Wine Smokers Junction	Basement And Ground Floor 355 Harrow Road London W9 3NA	Shop	Monday to Sunday; 07:00 - 23:00
08/10286/LIPDPS	Antello's Wine	Ground Floor 6 Great Western Road London W9 3NN	Shop	Sunday; 10:00 - 22:30   Monday to Saturday; 08:00 - 23:00
22/08225/LIPN	Not Recorded	359 Harrow Road London W9 3NA	Restaurant	Monday; 10:00 - 00:00   Tuesday; 10:00 - 00:00   Wednesday; 10:00 - 00:00   Thursday; 10:00 - 01:00   Friday; 10:00 - 01:00   Saturday; 10:00 - 01:00   Sunday; 10:00 -

				00:00
23/06139/LIPDPS	Tops Pizza	Ground Floor 8 Great Western Road London W9 3NN	Restaurant	Monday to Sunday; 11:00 - 00:00
23/02566/LIPV	Maida Hill Food And Wine	12 Great Western Road London W9 3NN	Shop	Monday; 08:00 - 02:00   Tuesday; 08:00 - 02:00   Wednesday; 08:00 - 02:00   Thursday; 08:00 - 02:00   Friday; 08:00 - 02:00   Saturday; 08:00 - 02:00   Sunday; 08:00 - 02:00
13/05167/LIPN	Maida Hill Place	4 Fernhead Road London W9 3ET	Miscellaneous	Sunday; 09:00 - 23:00   Monday to Saturday; 09:00 - 00:00
24/00119/LIPCH	Not Recorded	341A Harrow Road London W9 3RA	Restaurant	Monday to Sunday; 11:00 - 05:00
19/15810/LIPVM	Demipower Limited T/as KFC	Basement And Ground Floor 494 Harrow Road London W9 3QA	Takeaway food outlet	Friday to Saturday; 11:00 - 01:00   Sunday to Thursday; 11:00 - 00:00
23/09230/LIPDPS	O Sole Mio 1	Ground Floor 8 Fernhead Road London W9 3ET	Restaurant	Sunday; 11:00 - 22:30   Monday to Thursday; 09:00 - 00:00   Friday to Saturday; 09:00 - 01:00