



City of Westminster

# Licensing Sub-Committee Report

Item No:

Date:

3 October 2024

Licensing Ref No:

24/04729/LIPN - New Premises Licence

Title of Report:

21 Lansdowne Row  
20 - 21 Lansdowne Row  
London  
W1J 8QQ

Report of:

Executive Director – Environment & Communities

Wards involved:

West End

Policy context:

City of Westminster Statement of Licensing Policy

Financial summary:

None

Report Author:

Roxsana Haq  
Senior Licensing Officer

Contact details

Telephone: 020 7641 6500  
Email: rhaq@westminster.gov.uk

## 1. Application

1-A Applicant and premises			
<b>Application Type:</b>	New Premises Licence, Licensing Act 2003		
<b>Application received date:</b>	5 August 2024		
<b>Applicant:</b>	Hirmiz Ltd		
<b>Premises:</b>	21 Lansdowne Row		
<b>Premises address:</b>	20 - 21 Lansdowne Row London W1J 8QQ	<b>Ward:</b>	West End
		<b>Cumulative Impact Area:</b>	None
		<b>Special Consideration Zone:</b>	None
<b>Premises description:</b>	According to the application the premises is operating as a Moroccan cafe with shisha terrace. The cafe has operated for over a year and serves traditional tea and coffee, with plates of fruit, snacks and pastries.		
<b>Premises licence history:</b>	This is a new application therefore no premise licence history exists.		
<b>Applicant submissions:</b>	None		
<b>Applicant amendments:</b>	None		

1-B Proposed licensable activities and hours							
<b>Late Night Refreshment:</b>				<b>Indoors, outdoors or both</b>			Indoors
<b>Day:</b>	<b>Mon</b>	<b>Tues</b>	<b>Wed</b>	<b>Thur</b>	<b>Fri</b>	<b>Sat</b>	<b>Sun</b>
<b>Start:</b>	23:00	23:00	23:00	23:00	23:00	23:00	n/a
<b>End:</b>	23:30	23:30	23:30	23:30	00:00	00:00	n/a
<b>Seasonal variations/ Non-standard timings:</b>		None					

<b>Sale by retail of alcohol</b>				<b>On or off sales or both:</b>			Both
<b>Day:</b>	<b>Mon</b>	<b>Tues</b>	<b>Wed</b>	<b>Thur</b>	<b>Fri</b>	<b>Sat</b>	<b>Sun</b>
<b>Start:</b>	10:00	10:00	10:00	10:00	10:00	10:00	12:00
<b>End:</b>	23:30	23:30	23:30	23:30	00:00	00:00	22:30
<b>Seasonal variations/ Non-standard timings:</b>		None					

Hours premises are open to the public							
<b>Day:</b>	<b>Mon</b>	<b>Tues</b>	<b>Wed</b>	<b>Thur</b>	<b>Fri</b>	<b>Sat</b>	<b>Sun</b>
<b>Start:</b>	10:00	10:00	10:00	10:00	10:00	10:00	12:00
<b>End:</b>	23:30	23:30	23:30	23:30	00:00	00:00	22:30
<b>Seasonal variations/ Non-standard timings:</b>		None					
<b>Adult Entertainment:</b>		None					

## 2. Representations

2-A Responsible Authorities	
<b>Responsible Authority:</b>	Environmental Health Service
<b>Representative:</b>	Maxwell Koduah
<b>Received:</b>	29 August 2024

21 Lansdowne Row, 20 - 21 Lansdowne Row, London, W1J 8QQ

I refer to the new application for the above-mentioned premises. I have considered the information that you have provided within and accompanying this application. I have also considered the application in line with the relevant policies within the Councils Statement of Licensing Policy dated October 2021.

The applicant is seeking the following licensable activities:

1. The provision of late-night refreshment indoors Monday to Thursday 23:00 – 23:30 hours and Friday to Saturday 23:0 – 00:00 hours
2. The supply of alcohol for consumption on & off the premises at the following times  
Monday – Thursday 10:00 – 23:30 hours  
Friday – Saturday 10:00 – 00:00 hours  
Sunday 12:00 – 22:30 hours

**Following consideration of the application and how it may affect the Licensing Objectives meeting the requirements of the Council’s Statement of Licensing Policy I wish to make following representations:**

There is no information to demonstrate that appropriate and satisfactory general and technical risk assessments, management procedures have been undertaken, as part of the application, to ensure the public will be safe within and in the vicinity of the premises

The applicant is expected, according to the council’s Statement of Licensing Policy, October 2021, to have regard to the potential for nuisance associated with the style, characteristics and activities of the business. This assessment has to have regard to the proximity of residential accommodation and the inclusion of appropriate conditions as part of the operating schedule to ensure residents and businesses are not disturbed. Applicant has failed to demonstrate this.

For the above reasons, I make a representation on ground of public nuisance and public safety risk to the application.

If the committee is minded granting this application, then consideration may be given to the following conditions proposed to form part of the operating schedule

**Proposed conditions to form part of the operating schedule**

1. No noise generated on the premises, or by its associated plant or equipment, shall emanate from the premises nor vibration be transmitted through the structure of the premises which gives rise to a nuisance
2. All windows and external doors shall be kept closed after 21:00 hours, except for the immediate access and egress of persons
3. There shall be no sales of alcohol for consumption off the premises after 23.00 hours
4. All sales of alcohol for consumption off the premises shall be in sealed containers only,

and shall not be consumed on the premises

5. All outside tables and chairs shall be rendered unusable by 23.00 hours each day
6. A direct telephone number for the manager at the premises shall be publicly available at all times the premises is open. This telephone number and/or is to be made available to residents and businesses in the vicinity
7. During the hours of operation of the premises, the licence holder shall ensure sufficient measures are in place to remove and prevent litter or waste arising or accumulating from customers in the area immediately outside the premises, and that this area shall be swept and or washed, and litter and sweepings collected and stored in accordance with the approved refuse storage arrangements by close of business
8. All waste shall be properly presented and placed out for collection no earlier than 30 minutes before the scheduled collection times
9. No waste or recyclable materials, including bottles, shall be moved, removed from or placed in outside areas between 23.00 hours and 08.00 hours on the following day
10. No collections of waste or recycling materials (including bottles) from the premises shall take place between 23.00 and 08.00 hours on the following day
11. The supply of alcohol shall be by waiter or waitress service only
12. Food and non-intoxicating beverages, including drinking water, shall be available in all parts of the premises where alcohol is sold or supplied for consumption on the premises
13. A Challenge 21 or Challenge 25 proof of age scheme shall be operated at the premises where the only acceptable forms of identification are recognised photographic identification cards, such as a driving licence, passport or proof of age card with the PASS Hologram
14. No deliveries to the premises shall take place between 23.00 and 08.00 hours on the following day
15. No deliveries from the premises, either by the licensee or a third party shall take place between 23:00 and 08:00 hours on the following day
16. The approved arrangements at the premises, including means of escape provisions, emergency warning equipment, the electrical installation and mechanical equipment, shall at all material times be maintained in good condition and full working order
17. The means of escape provided for the premises shall be maintained unobstructed, free of trip hazards, be immediately available and clearly identified in accordance with the plans provided
18. No licensable activities shall take place at the premises until the premises has been assessed as satisfactory by the Environmental Health Consultation Team at which time this condition shall be removed from the Licence by the licensing authority
19. No licensable activities shall take at the premises until the capacity of the premises has been determined by the Environmental Health Consultation Team and the licensing authority has replaced this condition on the licence with a condition detailing the capacity so determined.

<b>Responsible Authority:</b>	Metropolitan Police Service
<b>Representative:</b>	PC Adam Deweltz
<b>Received:</b>	30 August 2024

Dear Westminster Licensing Services,

I am writing on behalf of the Commissioner of the Metropolitan Police Service ("The Police") to make representations opposing the grant of a premises licence application for 21 Lansdowne Row, W1J 8QQ

The application seeks the following licensable activities:

**Late Night Refreshment (Indoors):**

Monday – Thursday 23:00 – 23:30

Friday and Saturday: 23:00 – 00:00

**Alcohol (both On and Off Sales):**

Monday – Thursday 10:00 – 23:30

Friday and Saturday 10:00 – 00:00

Sunday 12:00 – 22:30

Following consideration of the application and how it may affect the Licensing Objectives, I wish to make the following representation:

The proposed licensable activities are likely to undermine the following licensing objective:

- The Prevention of Crime and Disorder.

The premises is located at 21 Lansdowne Row, W1J 8QQ. The Police have concerns that a new premises, which provides Alcohol and Late-Night Refreshment will adversely impact the area. Whilst the premises is not situated within Westminster's Cumulative Impact Zone or Special Consideration Zone, it is just outside of the SCZ. That area already has a busy and vibrant night life with many licensed premises located around Berkeley Square, W1. An extra bar in the area could cause further Policing issues with people becoming intoxicated. The police are already struggling to cope with excessive crime levels. This premises could also bring a rise in anti-social behaviour, which may impact on local residents.

Police did propose conditions to go on the premises licence should it be granted, but these conditions were not fully agreed to by the applicant. The purpose of requesting such conditions would likely reduce crime and disorder and allay the concerns of Police. The premises would also demonstrate that they are promoting the licensing objectives. The applicant has also failed to confirm whether this is a vertical drinking establishment, despite Police requests for this information.

Westminster's Statement of Licensing Policy 2021 states under its Public Houses and Bars Policy PB1:

**Public Houses and Bars Policy PB1**

*A. Applications outside the West End Cumulative Zone will generally be granted subject to:*

- 1. The application meeting the requirements of policies CD1, PS1, PN1 and CH1*

The Police request that the licensing sub-committee take into account all the above points.

Yours sincerely,

Adam.

PC Adam Deweltz 2556AW

**2-B Other Persons**

<b>Name:</b>	[REDACTED]		
<b>Address and/or Residents Association:</b>	[REDACTED] [REDACTED] [REDACTED]		
<b>Status:</b>	Valid	<b>In support or objection:</b>	OBJECTION
<b>Received:</b>	29 Aug 2024		

Dear Sir/Madam,

I am the owner of [REDACTED] located on [REDACTED] and I would like to object and protest against Hermiz cafe and barbershop located 20-21 Lansdowne Row, London W1J in acquiring a premises license.

I was made aware recently that they are now in the process of acquiring side the hot and cold beverages and alcoholic drinks. They serve any customers even if they are already turning up drunk or even minors, anything to make a sale. The landlord of all the premises on Lansdowne Row, London W1j which is the [REDACTED] is investigating them for breach of contract due to them making the premises into two separate business, a cafe and a barbershop instead of one business which is only allowed to be. [REDACTED] on four different occasions has sent their representatives to 20-21 Lansdowne Row, London W1J to discuss these breaches however, they are met with excuses such as the manger and owner not being present and available. I am stating these facts in order to point out Hermiz cafe 20-21 Lansdowne Row, London W1J, their total disregard for the landlord, the council and the law.

If you need any evidence of their breach e.g cctv footages or statements from customers and locals please ask myself or any other business on the Lansdowne row or the [REDACTED] which they will all gladly oblige.

Thank you

<b>Name:</b>	[REDACTED]		
<b>Address and/or Residents Association:</b>	[REDACTED] [REDACTED] [REDACTED]		
<b>Status:</b>	Valid	<b>In support or objection:</b>	OBJECTION
<b>Received:</b>	27 Aug 2024		

Dear Sir/Madam,

I would like to introduce myself as the owner of [REDACTED] [REDACTED] I would like to contest and object to Hirmiz cafe and barbershop on 20-21 Lansdowne row in granting them a premises license due to the fact that they are already serving alcohol and hot & cold beverages for more than a year illegally with them not having the license to do so.

This is affecting my business [REDACTED] d directly due to them serving alcohol illegally to members of the public being underage or individuals already being intoxicated when they arrive there, since they don't serve hot food their customers come into my establishment drunk and violent and hurling verbal abuses at my staff as they try to order food. This has affected my staff's physical and mental state, as well as my own and would be accurate to say the other establishment and their staff on Lansdowne row feel the same. Since the opening of 20-21 Lansdowne Row, anti social behaviour, violence and crime has increased on Lansdowne Row because of their illegal and unethical way of conducting their business. I would like to remind you that serving alcohol without a license is a criminal prosecution.

Thank you for your time and consideration.

### 3. Policy & Guidance

The following policies within the City of Westminster Statement of Licensing Policy apply:	
<b>Core Hours Policy HRS1 applies</b>	A. Applications within the core hours set out below in this policy will generally be granted for the relevant premises uses, subject to not being contrary to other policies in the Statement of Licensing Policy.
<b>Pubs and Bars Policy PB1(A) applies</b>	<p><b>A. Applications outside the West End Cumulative Zone will generally be granted subject to:</b></p> <ol style="list-style-type: none"> <li>1. The application meeting the requirements of policies CD1, PS1, PN1 and CH1.</li> <li>2. The hours for licensable activities being within the council's Core Hours Policy HRS1.</li> <li>3. The applicant has taken account of the Special Consideration Zones policy SCZ1 if the premises are located within a designated zone.</li> <li>4. The application and operation of the venue meet the definition of a Public House or Bar in Clause D.</li> </ol> <p><b>B. It is the Licensing Authority's policy to refuse applications within the West End Cumulative Impact Zone other than:</b></p> <ol style="list-style-type: none"> <li>1. Applications to vary the existing licence hours within the council's Core Hours Policy HRS1.</li> <li>2. Applications that seek to vary the existing licence so as to reduce the overall capacity of the premises.</li> </ol> <p><b>C. The applications referred to in Clause B1 and B2 will generally be granted subject to:</b></p> <ol style="list-style-type: none"> <li>1. The application meeting the requirements of policies CD1, PS1, PN1 and CH1, and/or,</li> <li>2. The application and operation of the venue continuing to meet the definition of a Public House or Bar in Clause D.</li> </ol> <p><b>D. For the purposes of this policy a Public House or Bar is defined as a premises, or part of a premises that's primary use is the sale or supply of alcohol for consumption on those premises and/or for consumption off the premises for consumption outside the venue.</b></p>

### 4. Equality Implications

The Council in its capacity as Licensing Authority has a duty to have regard to its public sector equality duty under section 149 of the Equality Act 2010. In summary, section 149 provides that a Public Authority must, in the exercise of its functions, have due regard to the need to:

- (a) eliminate discrimination harassment, victimisation and any other conduct that is prohibited by or under this Act;

- (b) advance equality of opportunity between persons who share a relevant protected characteristic and persons who do not share it; and
- (c) foster good relations between persons who share a relevant protected characteristics and persons who do not share it.

Section 149 (7) of the Equality Act 2010 defines the relevant protected characteristics as age, disability, gender reassignment, marriage and civil partnership, pregnancy and maternity, race, religion or belief, sex, and sexual orientation.

## 5. Appendices

<b>Appendix 1</b>	Premises plans
<b>Appendix 2</b>	Applicant supporting documents
<b>Appendix 3</b>	Premises history
<b>Appendix 4</b>	Proposed conditions
<b>Appendix 5</b>	Residential map and list of premises in the vicinity

<b>Report author:</b>	Ms Roxsana Haq Senior Licensing Officer
<b>Contact:</b>	Telephone: 020 7641 6500 Email: rhaq@westminster.gov.uk

**If you have any queries about this report or wish to inspect one of the background papers please contact the report author.**

### **Background Documents – Local Government (Access to Information) Act 1972**

<b>1</b>	Licensing Act 2003	N/A
<b>2</b>	City of Westminster Statement of Licensing Policy	01 October 2021
<b>3</b>	Amended Guidance issued under section 182 of the Licensing Act 2003	December 2023
<b>4</b>	Cumulative Impact Assessment	04 December 2023
<b>5</b>	Environmental Health Service representation	29 August 2024
<b>6</b>	Metropolitan Police Service representation	30 August 2024
<b>7</b>	Interested Party 1	29 August 2024
<b>8</b>	Interested Party 2	27 August 2024



**Premises Plans**

**Appendix 1**

Basement  
Hirmiz Cafe - 21 Lansdowne Row, London W1J 8QQ

Please note, the basement runs the full length of the shops and businesses on the row and is purely to detail whereabouts the toilets are for Hirmiz Cafe.

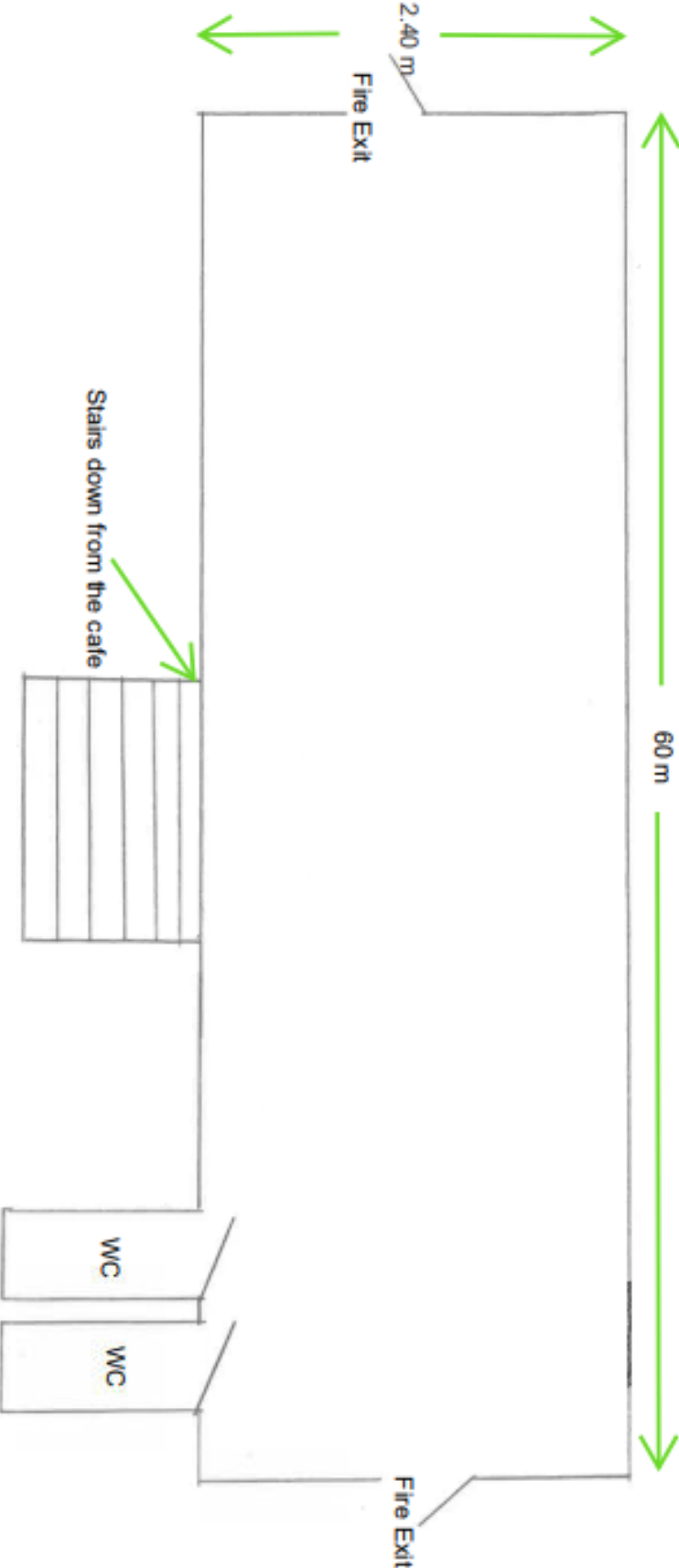

Himmiz Café - 21 Lansdowne Row, London W1J 8QQ

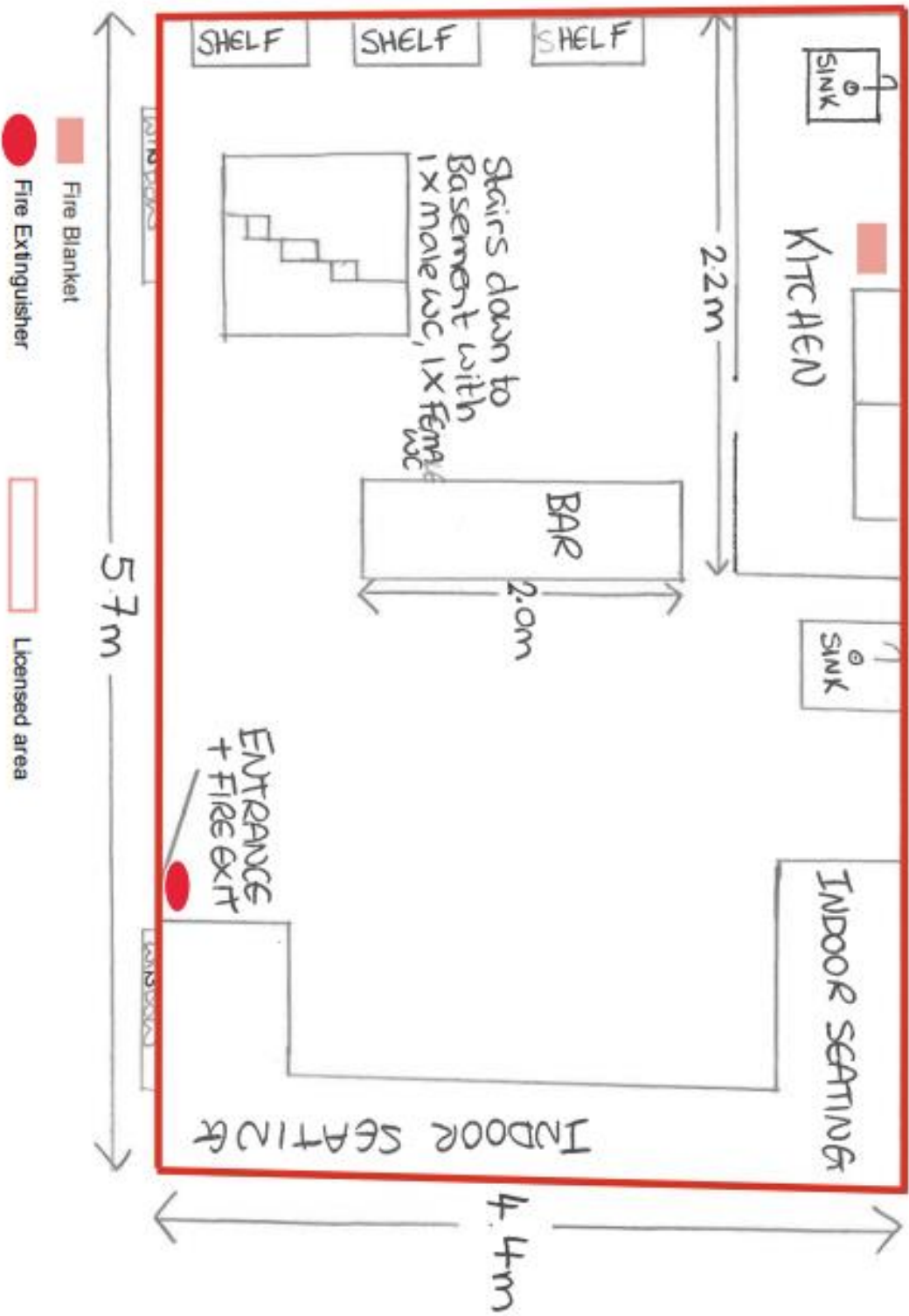

Herritz Cafe - 21 Lansdowne Row, London W1J 8QQ

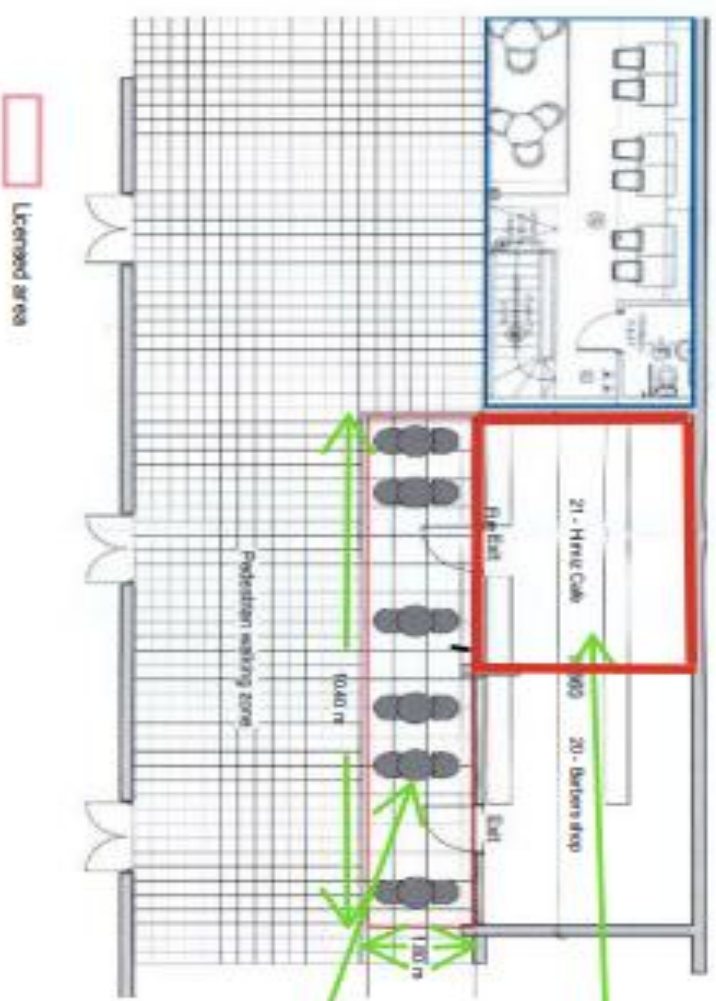

Please see more detailed plan which details the inside of the premises

This is the outside of number 20 and 21 Lansdowne Row for which the applicant has applied for a pavement licence, 6 x tables.

## **Applicant Supporting Documents**

## **Appendix 2**

There are no supporting documents from the applicant.

## **Premises History**

## **Appendix 3**

There is no licence or appeal history for the premises.

### **CONDITIONS CONSISTENT WITH THE OPERATING SCHEDULE AND CONDITIONS PROPOSED BY A PARTY TO THE HEARING**

When determining an application for a new premises licence under the provisions of the Licensing Act 2003, the licensing authority must, unless it decides to reject the application, grant the licence subject to the conditions which are indicated as mandatory in this schedule.

At a hearing the licensing authority may, in addition, and having regard to any representations received, grant the licence subject to such conditions which are consistent with the operating schedule submitted by the applicant as part of their application, or alter or omit these conditions, or add any new condition to such extent as the licensing authority considers necessary for the promotion of the licensing objectives.

This schedule lists those conditions which are consistent with the operating schedule, or proposed as necessary for the promotion of the licensing objectives by a responsible authority or an interested party as indicated. These conditions have not been submitted by the licensing service but reflect the positions of the applicant, responsible authority or interested party and have not necessarily been agreed

#### **Mandatory Conditions**

1. No supply of alcohol may be made at a time when there is no designated premises supervisor in respect of this licence.
2. No supply of alcohol may be made at a time when the designated premises supervisor does not hold a personal licence or the personal licence is suspended.
3. Every supply of alcohol under this licence must be made or authorised by a person who holds a personal licence.
4.
  - (1) The responsible person must ensure that staff on relevant premises do not carry out, arrange or participate in any irresponsible promotions in relation to the premises.
  - (2) In this paragraph, an irresponsible promotion means any one or more of the following activities, or substantially similar activities, carried on for the purpose of encouraging the sale or supply of alcohol for consumption on the premises—
    - (a) games or other activities which require or encourage, or are designed to require or encourage, individuals to;
      - (i) drink a quantity of alcohol within a time limit (other than to drink alcohol sold or supplied on the premises before the cessation of the period in which the responsible person is authorised to sell or supply alcohol), or
      - (ii) drink as much alcohol as possible (whether within a time limit or otherwise);
    - (b) provision of unlimited or unspecified quantities of alcohol free or for a fixed or discounted fee to the public or to a group defined by a particular characteristic in a manner which carries a significant risk of undermining a licensing objective;
    - (c) provision of free or discounted alcohol or any other thing as a prize to encourage or reward the purchase and consumption of alcohol over a period of 24 hours or

less in a manner which carries a significant risk of undermining a licensing objective;

- (d) selling or supplying alcohol in association with promotional posters or flyers on, or in the vicinity of, the premises which can reasonably be considered to condone, encourage or glamorise anti-social behaviour or to refer to the effects of drunkenness in any favourable manner;
  - (e) dispensing alcohol directly by one person into the mouth of another (other than where that other person is unable to drink without assistance by reason of a disability).
5. The responsible person must ensure that free potable water is provided on request to customers where it is reasonably available.
6. (1) The premises licence holder or club premises certificate holder must ensure that an age verification policy is adopted in respect of the premises in relation to the sale or supply of alcohol.
- (2) The designated premises supervisor in relation to the premises licence must ensure that the supply of alcohol at the premises is carried on in accordance with the age verification policy.
- (3) The policy must require individuals who appear to the responsible person to be under 18 years of age (or such older age as may be specified in the policy) to produce on request, before being served alcohol, identification bearing their photograph, date of birth and either—
- (a) a holographic mark, or
  - (b) an ultraviolet feature.
7. The responsible person must ensure that—
- (a) where any of the following alcoholic drinks is sold or supplied for consumption on the premises (other than alcoholic drinks sold or supplied having been made up in advance ready for sale or supply in a securely closed container) it is available to customers in the following measures—
    - (i) beer or cider: ½ pint;
    - (ii) gin, rum, vodka or whisky: 25 ml or 35 ml; and
    - (iii) still wine in a glass: 125 ml;
  - (b) these measures are displayed in a menu, price list or other printed material which is available to customers on the premises; and
  - (c) where a customer does not in relation to a sale of alcohol specify the quantity of alcohol to be sold, the customer is made aware that these measures are available.

A responsible person in relation to a licensed premises means the holder of the premise licence in respect of the premises, the designated premises supervisor (if any) or any individual aged 18 or over who is authorised by either the licence holder or designated premises supervisor. For premises with a club premises certificate, any member or officer of the club present on the premises in a capacity that which enables him to prevent the supply of alcohol.

8(i) A relevant person shall ensure that no alcohol is sold or supplied for consumption on or off the premises for a price which is less than the permitted price.

8(ii) For the purposes of the condition set out in paragraph 8(i) above -

(a) "duty" is to be construed in accordance with the Alcoholic Liquor Duties Act 1979;

(b) "permitted price" is the price found by applying the formula -

$$P = D + (D \times V)$$

Where -

(i) P is the permitted price,

(ii) D is the amount of duty chargeable in relation to the alcohol as if the duty were charged on the date of the sale or supply of the alcohol, and

(iii) V is the rate of value added tax chargeable in relation to the alcohol as if the value added tax were charged on the date of the sale or supply of the alcohol;

(c) "relevant person" means, in relation to premises in respect of which there is in force a premises licence -

(i) the holder of the premises licence,

(ii) the designated premises supervisor (if any) in respect of such a licence, or

(iii) the personal licence holder who makes or authorises a supply of alcohol under such a licence;

(d) "relevant person" means, in relation to premises in respect of which there is in force a club premises certificate, any member or officer of the club present on the premises in a capacity which enables the member or officer to prevent the supply in question; and

(e) "value added tax" means value added tax charged in accordance with the Value Added Tax Act 1994.

8(iii). Where the permitted price given by Paragraph 8(ii)(b) above would (apart from this paragraph) not be a whole number of pennies, the price given by that sub-paragraph shall be taken to be the price actually given by that sub-paragraph rounded up to the nearest penny.

8(iv). (1) Sub-paragraph 8(iv)(2) below applies where the permitted price given by Paragraph 8(ii)(b) above on a day ("the first day") would be different from the permitted price on the next day ("the second day") as a result of a change to the rate of duty or value added tax.

(2) The permitted price which would apply on the first day applies to sales or supplies of alcohol which take place before the expiry of the period of 14 days beginning on the second day.



## **Conditions consistent with the operating schedule**

None.

## **Conditions proposed by the Environmental Health Service.**

9. No noise generated on the premises, or by its associated plant or equipment, shall emanate from the premises nor vibration be transmitted through the structure of the premises which gives rise to a nuisance
10. All windows and external doors shall be kept closed after 21:00 hours, except for the immediate access and egress of persons
11. There shall be no sales of alcohol for consumption off the premises after 23.00 hours
12. All sales of alcohol for consumption off the premises shall be in sealed containers only, and shall not be consumed on the premises
13. All outside tables and chairs shall be rendered unusable by 23.00 hours each day
14. A direct telephone number for the manager at the premises shall be publicly available at all times the premises is open. This telephone number and/or is to be made available to residents and businesses in the vicinity
15. During the hours of operation of the premises, the licence holder shall ensure sufficient measures are in place to remove and prevent litter or waste arising or accumulating from customers in the area immediately outside the premises, and that this area shall be swept and or washed, and litter and sweepings collected and stored in accordance with the approved refuse storage arrangements by close of business
16. All waste shall be properly presented and placed out for collection no earlier than 30 minutes before the scheduled collection times
17. No waste or recyclable materials, including bottles, shall be moved, removed from or placed in outside areas between 23.00 hours and 08.00 hours on the following day
18. No collections of waste or recycling materials (including bottles) from the premises shall take place between 23.00 and 08.00 hours on the following day
19. The supply of alcohol shall be by waiter or waitress service only
20. Food and non-intoxicating beverages, including drinking water, shall be available in all parts of the premises where alcohol is sold or supplied for consumption on the premises
21. A Challenge 21 or Challenge 25 proof of age scheme shall be operated at the premises where the only acceptable forms of identification are recognised photographic identification cards, such as a driving licence, passport or proof of age card with the PASS Hologram
22. No deliveries to the premises shall take place between 23.00 and 08.00 hours on the following day
23. No deliveries from the premises, either by the licensee or a third party shall take place between 23:00 and 08:00 hours on the following day

24. The approved arrangements at the premises, including means of escape provisions, emergency warning equipment, the electrical installation and mechanical equipment, shall at all material times be maintained in good condition and full working order
25. The means of escape provided for the premises shall be maintained unobstructed, free of trip hazards, be immediately available and clearly identified in accordance with the plans provided
26. No licensable activities shall take place at the premises until the premises has been assessed as satisfactory by the Environmental Health Consultation Team at which time this condition shall be removed from the Licence by the licensing authority
27. No licensable activities shall take at the premises until the capacity of the premises has been determined by the Environmental Health Consultation Team and the licensing authority has replaced this condition on the licence with a condition detailing the capacity so determined.

**Conditions proposed by the Metropolitan Police Service.**

28.
  - (a) The premises shall install and maintain a comprehensive CCTV system as per the minimum requirements of the Westminster Police Licensing Team.
  - (b) All entry and exit points will be covered enabling frontal identification of every person entering in any light condition.
  - (c) The CCTV system shall continually record whilst the premises is open for licensable activities and during all times when customers remain on the premises and will include the external area immediately outside the premises entrance.
  - (d) All recordings shall be stored for a minimum period of 31 days with date and time stamping.
  - (e) Viewing of recordings shall be made available immediately upon the request of Police or authorised officer throughout the entire 31-day period.
29. A staff member from the premises who is conversant with the operation of the CCTV system shall be on the premises at all times when the premises is open. This staff member must be able to provide a Police or authorised council officer copies of recent CCTV images or data with the absolute minimum of delay when requested.
30. There shall be a personal licence holder on duty on the premises at all times when the premises are authorised to sell alcohol.
31. Challenge 25 proof of age scheme shall be operated at the premises where the only acceptable forms of identification are recognised photographic identification cards, such as a driving licence, passport or proof of age card with the PASS Hologram.
32. An incident log shall be kept at the premises, and made available on request to an authorised officer of the City Council or the Police. It must be completed within 24 hours of the incident and will record the following:
  - (a) all crimes reported to the venue
  - (b) all ejections of patrons
  - (c) any complaints received concerning crime and disorder
  - (d) any incidents of disorder
  - (e) all seizures of drugs or offensive weapons
  - (f) any faults in the CCTV system
  - (g) any refusal of the sale of alcohol
  - (h) any visit by a relevant authority or emergency service.

33. Save for the outside tables and chairs, all sales of alcohol for consumption off the premises shall be in sealed containers only, and shall not be consumed on the premises.
34. Alcohol consumed outside the premises building shall only be consumed by patrons seated at tables.
35. All outside tables and chairs shall be rendered unusable by 23.00 hours each day.
36. Substantial food and non-intoxicating beverages, including drinking water, shall be available in all parts of the premises where alcohol is sold or supplied for consumption on the premises.

20 - 21 Lansdowne Row, London W1J 8QQ

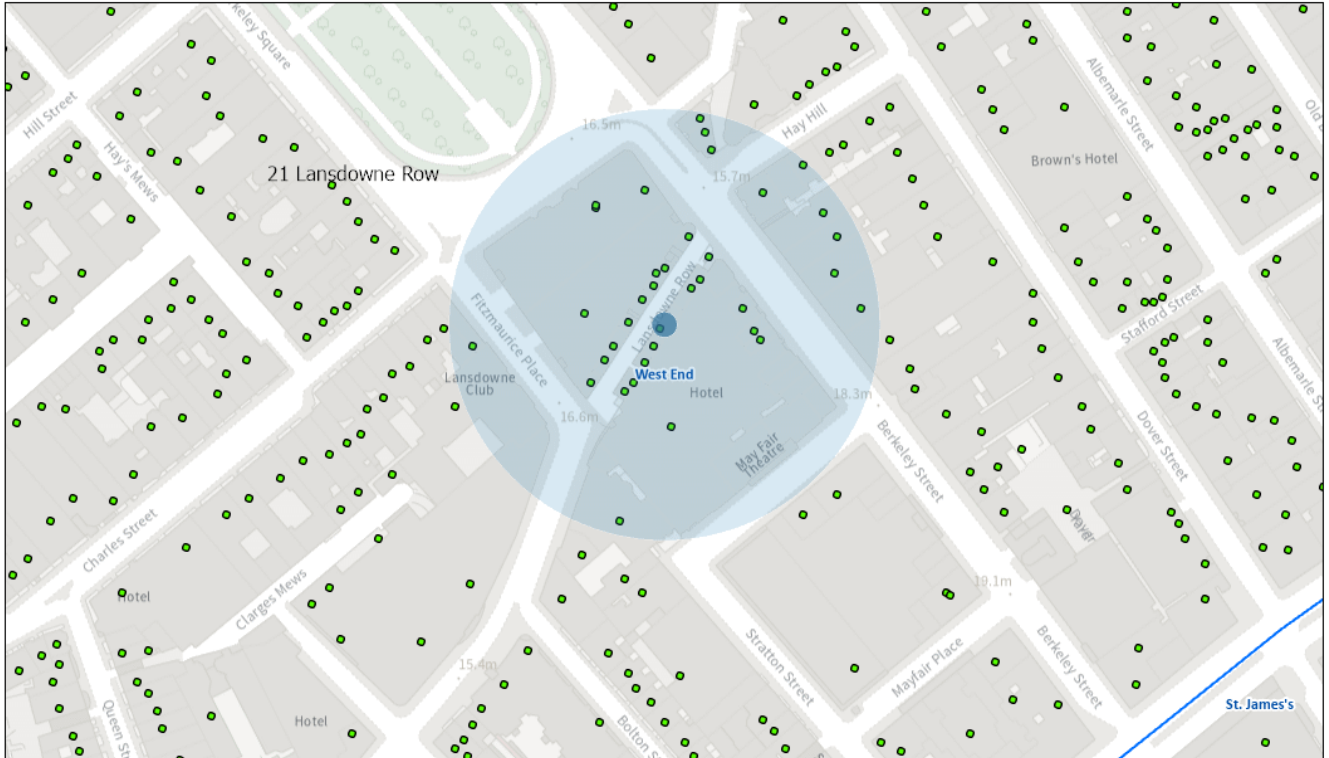

20/09/2024, 15:11:56

- Property Mailing List
- Ward Boundaries
- Ward Labels

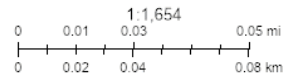

**Resident Count: 27**

Licensed premises within 75m of 20 - 21 Lansdowne Row, London W1J 8QQ				
Licence Number	Trading Name	Address	Premises Type	Time Period
21/07229/LIPN	La Strada	Basement And Ground Floor 4 - 5 Lansdowne Row London W1J 6DS	Cafe	Monday to Sunday; 08:00 - 23:00
22/06590/LIPCH	Baku Bistro	22 - 24 Lansdowne Row London W1J 8QL	Restaurant	Sunday; 07:00 - 23:00   Monday to Thursday; 07:00 - 00:00   Friday to Saturday; 07:00 - 00:30   Sundays before Bank Holidays; 07:00 - 00:00

21/04073/LIPN	Not Recorded	11 - 12 Lansdowne Row London W1J 6DY	Not Recorded	Sunday; 07:00 - 23:00   Monday to Thursday; 07:00 - 23:00   Friday to Saturday; 07:00 - 00:00
23/04855/LIPDPS	Palm Beach Casino	30 Berkeley Street London W1J 8EH	Casino or gambling club	Sunday; 12:00 - 07:00   Monday to Saturday; 10:00 - 07:00
22/07888/LIPDPS	Be At One	59 Berkeley Square London W1S 4EA	Night clubs and discos	Sunday; 09:00 - 01:00   Monday to Saturday; 09:00 - 03:30
23/08482/LIPVM	20 Berkeley	20 Berkeley Street London W1J 8EE	Restaurant	Sunday; 08:00 - 22:30   Monday to Thursday; 08:00 - 23:30   Friday to Saturday; 08:00 - 00:00
23/04834/LIPDPS	Park Chinois	Basement And Ground Floor 17 Berkeley Street London W1J 8EA	Restaurant	Sunday; 10:00 - 00:00   Monday to Saturday; 08:00 - 02:00
23/01498/LIPDPS	Bocconcino	19 Berkeley Street London W1J 8ED	Restaurant	Sunday; 12:00 - 22:30   Monday to Saturday; 10:00 - 00:30
24/01775/LIPDPS	Radisson Edwardian The Mayfair Hotel	17 Stratton Street London W1J 8LT	Hotel, 4+ star or major chain	Monday to Sunday; 00:00 - 00:00